

ZAP Controls

Series II Commercial Operator Catalog



ZAP Series II Simply Logical

ZAP Controls
100 Waterloo Blvd. Anglesey Business Park, Littleworth Road, Cannock, Staffordshire, England
UK Office Number 011-44-154-387-9444 sales@zap-uk.com
Online www.zap-uk.com

ZAP Controls
Series II Commercial Operator Catalog

ZAP Controls

Table of Contents

Commercial Operators	4
825-II Medium Duty Sectional Door Operator	5
8825-II Heavy Duty Sectional Door Operator	7
8826-II Heavy Duty Sectional Door Operator with Hoist	9
8825-II HP B Industrial Duty Sectional Door Operator	11
8825-II HP C/D Industrial Duty Sectional Door Operator	13
8855 Turbo Drive High Speed Sectional Door Operator	15
815-II SL Dead Axle Sheet Door Operator	17
8815-II SD Dead Axle Sheet Door Operator	19
825-II SS Live Axle Sheet Door Operator	21
827-II Compact Dead Axle Operator	23
Accessories	25
(871) Interface Expansion Module	26
(871-FS) Fire Station Module	27
(872) Adapter module	28
(8070) Auto-Lock	29
(8830) Battery Back Up	30
(82DTLM) Dock Interlock with driver communication light control	31
(ZA0192) Slave Relay adapter kit for 82DTLM	32
(822) Dock Interlock with advance closure warning	33
(82TLM) Through traffic light control/Door closed interlock	34
(821) Through traffic light control with advance closure warning	35
(850) Beeper Module	36
(401002) UL325 Photo eye	37
(401001) Non UL325 Photo Eye for Fire Station Module	38
(840,2414,2416) Receiver and Antennas	39
(4305-A, 4202,4113) Handheld Radio Control Transmitters	40
(4500-50, 4500-66) Forklift Radio Control Transmitters	41
(1100,1102,1104) Loop detectors	42
Parts Section	43
ZAP Motor, Pulley, Belt Replacement/Configuration chart	44
Parts-Motor Head components	45
Parts-Controller/Accessory components	46

ZAP Series II Simply Logical

ZAP Controls
100 Waterloo Blvd. Anglesey Business Park, Littleworth Road, Cannock, Staffordshire, England
UK Office Number 011-44-154-387-9444 sales@zap-uk.com
Online www.zap-uk.com

ZAP Controls

Series II Commercial Operator Brochures and Specifications

ZAP Controls
Series II Commercial Operator Brochures and Specifications



ZAP Series II Simply Logical

ZAP Controls
100 Waterloo Blvd. Anglesey Business Park, Littleworth Road, Cannock, Staffordshire, England
UK Office Number 011-44-154-387-9444 sales@zap-uk.com
Online www.zap-uk.com

ZAP Controls

825 Series II Super Drive

Safety

- Compact size reduces potential for lifting injuries during installation
- Universal torsion shaft mounting system reduces the potential for unsafe work practices during installation
- Fully adjustable automatic obstruction sensing system detects obstructions on any part of the door in the open or close direction while monitoring the entire door movement for unsafe operation or service conditions
- Inherent soft start-soft stop, safety stop-reverse eliminates the mechanical stress damage to the door when the door reverses
- Self determining limit system prevents thrown cables from debris, ice, and snow left in the door opening

Value

- Continuous duty rated low voltage motor
- Ultra-Quiet DC Motor, will not thermally overload
- Built in service due reminder may be activated to ensure regular maintenance based on cycles of usage
- Fully programmable timer-to-close
- Built in interlock terminals to prevent door operation
- Programmable mid-stop
- Motor maximum amperage draw 2.8 Amps reducing number circuits required for multiple door applications
- Automatic obstruction sensing system surpasses the capabilities of a sensing edge detecting obstructions on any part of the door, eliminating the cost of a safety edge and associated wiring
- Reduces the occurrence of catastrophic damage to the door

Simplicity

- Simple one person installation that eliminate steel build ups, back hangs, welding, and specialty anchors
- Simplistic maintenance design concept
- PCB based system controller eliminates the cost of servicing electrical contactors, limit systems, and countless other parts
- When the operator emergency release lever is disengaged the door easily operates by hand
- Operates all lifts of sectional doors with counter-weights or torsion springs, including rear mount torsion
- Versatile sectional door application mounting. May be mounted vertically, horizontally, upside down, inside the cable drum, rear mount torsion, all without requiring wall or ceiling mount
- Simple wiring configurations and accessory modules that eliminate external limit relays to achieve various interlock configurations

Reliability

- Industrial components ensure years of service
- Motor and controller eliminates the problem of stuck motor switches, limit system failures, burned out starting capacitors and A/C motor malfunctions



ZAP Controls
825 Series II Super-Drive
Torsion Shaft Mounted DC Commercial Sectional Door Operator

Technical information for the 825 Series II

Controller dimensions:	6.5" H X 5.4" W X 4" D
Single phase voltage:	115V US, 208-230V US, 230V EU
Amp draw:	2.8A
Power rating:	650 Newtons Equivalent 1/2 HP
Control circuit voltage:	6VDC
Limits determination:	Physical/Self Calibrating
Duty cycle rating:	Continuous
Operating temp range:	-22 deg F to 212 deg F
Overload protection:	Inherent motor current sensing
Lubrication:	Permanent
Torsion shaft type required:	Solid w/keyway or hollow tube
Fits torsion shafts diameter:	1"
Torsion shaft length required:	4.5" beyond outer track edge
Side clearance required:	4.5min for motor only
Replacement motor PN	600805
Replacement belt PN/size	825-B 600612 (AX22) 825-C 600602 (AX23) 825-D 600615 (AX25)

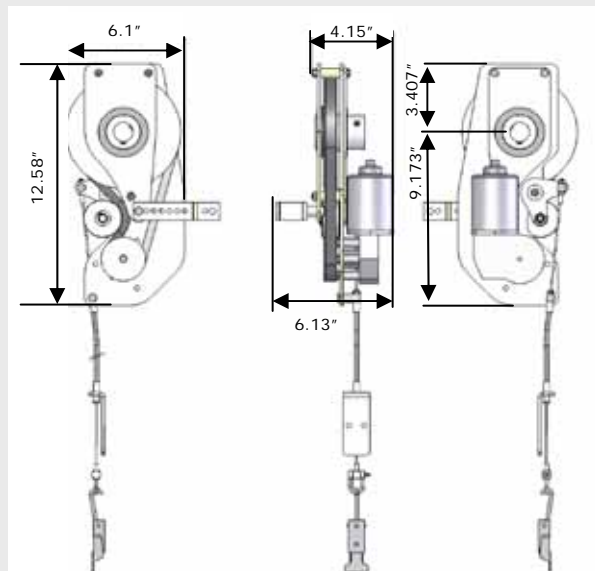

825 II US

ZAP Series II

Simply Logical

Not For Use In Residential Applications

ZAP Controls
100 Waterloo Blvd. Anglesey Business Park, Littleworth Road, Cannock, Staffordshire, England
UK Office Number 011-44-154-387-9444 sales@zap-uk.com
Online www.zap-uk.com

ZAP Controls

825 Series II Super-Drive

Commercial DC Sectional Door Operator

Lift Requirement	Low Headroom	Standard Lift	High Lift to 54"	High Lift above 54"	Vertical Lift
Door Size W X H					
8'-20'W X 6'-8'6" H	825-II-B	825-II-B	825-II-C	825-II-D	825-II-D
8'-10'W X 8'6"-10' H	825-II-B	825-II-B	825-II-C	825-II-D	See 8825-II-D

Please read the instructions fully or attend training online before installation. Consult factory for door sizes beyond scope provided above. The maximum door weight for sizes listed above is 600 Lbs. The minimum door height is 6'.

Standard Features

- Motor and Controller**
 Continuous duty rated DC Motor with controller, producing a powerful soft start/soft stop output of 650 Newtons of force to drive commercial sectional doors while reducing mechanical impacts that cause premature wear of door components.
- Drive Reduction**
 Worm drive gearbox & V-belt reduction drive with floor level, adjustable belt tensioning /emergency release lever.
- Bearings and Belts**
 Drive systems use industrial grade bearings and automotive grade long life v-belts. Our simplistic service design concept allows simple service of components in a matter of moments.
- Construction**
 Heavy-duty 8-gauge electro-plate finish steel frame, industrial bearings, worm drive gear box, aluminum drive pulley, secured with key stock and set screw for simple servicing.
- Push Button Station**
 Control unit acts as the standard 3-button station for open/close/stop functions. Controller may mounted remotely up to 24 feet away from the operator, provided it is to be wired with other external control devices that are designed to function as the primary door controls. Power supply is wired directly to the controller not the motor. Low voltage motor cable is supplied for easy wiring of the motor.

Value Added Standard Features

- Automatic Obstruction Sensing System**
 Inherent motor current sensing system monitors the entire door system for obstructions and unsafe operating conditions in both directions of travel. The system provides protections unavailable with traditional commercial operators and can automatically sense obstructions like locks, broken springs, unsafe service conditions, and other obstructions that cannot be detected by reversing edges and photo cells.
- Safety Stop and Reverse**
 Inherent motor current sensing system automatically incorporates and safety stop before reopening in soft start.
- Auto-Close Timer**
 Fully programmable auto-close timer automatically closes the door. (4 minutes) Requires the addition of approved photo cell.
- Part Open Programming (Programmable Mid Stop)**
 Programmable part open to stop door at predetermined height.
- Prevent door operation interlock**
 Built in interlock to prevent door operation, used with truck restraint systems, shared track applications or pass doors.
- Max run time protection**
 Inherent motor current sensing system provides automatic max runtime protection.
- Service Due reminder**
 May be activated to ensure regularly scheduled maintenance based on cycles of usage.

- Emergency Egress Manual Operation**
 Emergency manual operation using a ground level over-ride lever disconnect. When lever is released, the door will operate manually by hand as if no operator is connected to the door. This unique system eliminates the need to electrically interlock the disconnect as the operator has no mechanical limits and physically disconnects from all drive systems when released. It also provides ground level adjustment of the motor drive belt.
- Versatile mounting configurations**
 825-II may be mounted in standard vertical, horizontal, inverted, inverted center mount inside the cable drum, or rear mount torsion configurations. Some applications may require the use of a longer Bowden cable for proper installation.

Options and Accessories

- Through Beam and Retro-reflective Photo Eyes**
 401001 through beam commercial grade 4 wire photo eye
 401000 retro-reflective commercial grade 4 wire photo eye
- Motor Cover**
 A motor cover suitable for wet locations is available. PN 8260
- Receivers and Transmitters**
 2, 4, and 6 button handheld and permanently mounted forklift transmitters are available for use with the model 840 receiver. The 840 receiver module can use either an internal or optional external antenna.
- Auto-Lock**
 8070 Auto-Lock provides integrated security with an electronic solenoid locking system that releases a shoot bolt above a roller when door is stopped and withdraws prior to door operation.
- Rear mount torsion kit**
 ZA0102 Bowden cable. 900005 Large offset torque arm.
- Battery Back Up**
 8830 Battery Back up systems allows operation of the operator during power outages.

Available Plug-in Modules

- Auxiliary Input Expansion Module**
 871 module allows for expansion of input functions and the application of external radio receivers from other manufacturers
- Fire Station module**
 871 FS allows the incorporation of a second set of photo cells above man traffic height that will prevent the auto-close timer from timing out and closing a door before the vehicle has departed the facility. Once the vehicle has departed the opening fully, the timer is released.
- Dock interlock/Traffic light control w/adv. warning**
 82DTLM and the 822 Modules provide a N/O relay that closes when the door operator is in the fully opened position. It may be used as a dock interlock or to interlock a door that shares the same track system. Provides terminals to operate red/green driver communication lighting where mechanical dock levelers are used. 822 module provides advance warning of pending door closure with activation of the delay close programming. Terminals provided on 82DTLM may also be used to operate security, heating or other 5V to 240V devices up to 5 amps. Expansion port included for the addition of 8070 Auto-Lock, 871 FS, or 871 interface expansion modules.
- Closed interlock/Traffic light control w/adv. warning**
 82TLM and the 821 Modules provide a N/O relay that closes when the door operator is in the fully closed position. It may be used as a sally port interlock or to interlock any device that requires the door to be in the closed position. Provides terminals to operate red/green through traffic lights where it is desired to know the door is fully opened before proceeding through. 821 module provides advance warning of pending door closure with activation of the delay close programming. Terminals provided may also be used to operate security, heating or other 5V to 240V devices up to 5 amps. Expansion port is included for the addition of 8070 Auto-Lock, 871 FS, or 871 input expansion modules.
- Loop Detectors**
 Both single, and twin loop detectors are available for either plug in or wall mount installation.

ZAP Controls

8825 Series II Super Drive

Safety

- Compact size reduces potential for lifting injuries during installation
- Universal torsion shaft mounting system reduces the potential for unsafe work practices during installation
- Fully adjustable automatic obstruction sensing system detects obstructions on any part of the door in the open or close direction while monitoring the entire door movement for unsafe operation or service conditions
- Inherent soft start-soft stop, safety stop-reverse eliminates the mechanical stress damage to the door when the door reverses
- Self determining limit system prevents thrown cables from debris, ice, and snow left in the door opening

Value

- Continuous duty rated low voltage motor
- Ultra-Quiet DC Motor, will not thermally overload
- Built in Service Due reminder may be activated to ensure regular maintenance based on cycles of usage
- Fully programmable Timer-to-close
- Built in interlock terminals to prevent door operation
- Programmable mid-stop
- Motor maximum amperage draw 3.2 Amps reducing number circuits required for multiple door applications
- Automatic obstruction sensing system surpasses the capabilities of a sensing edge detecting obstructions on any part of the door, eliminating the cost of a safety edge and associated wiring
- Reduces the occurrence of catastrophic damage to the door

Simplicity

- Simple one person installation that eliminate steel build ups, back hangs, welding, and specialty anchors
- Simplistic maintenance design concept
- PCB based system controller eliminates the cost of servicing electrical contactors, limit systems, and countless other parts
- When the operator emergency release lever is disengaged the door easily operates by hand
- Operates all lifts of sectional doors with counter-weights or torsion springs, including rear mount torsion
- Versatile sectional door application mounting. May be mounted vertically, horizontally, upside down, inside the cable drum, rear mount torsion, all without requiring wall or ceiling mount
- Simple wiring configurations and accessory modules that eliminate external limit relays to achieve various interlock configurations

Reliability

- Industrial components ensure years of service
- Long life phosphor bronze worm drive gear system
- DC Motor and controller eliminates the problem of stuck motor switches, limit system failures, burned out starting capacitors and A/C motor malfunctions



ZAP Controls
8825 Series II Super-Drive
Torsion Shaft Mounted DC Commercial Sectional Door Operator

Technical information for the 8825 Series II

Controller dimensions:	6.5" H X 8.7" W X 4.7" D
Single phase voltage:	115V US, 208-230V US, 230V EU, 480V US
Three phase voltage:	(Special order) 8825(X)-3-480
Amp draw:	3.2A
Power rating:	1300 Newtons Equivalent to 1 HP
Control circuit voltage:	6VDC
Limits determination:	Physical/Self Calibrating
Duty cycle rating:	Continuous
Operating temp range:	-20 deg F to 212 deg F
Overload protection:	Inherent motor current sensing
Lubrication:	Permanent
Torsion shaft type required:	Solid w/keyway or hollow tube
Fits torsion shafts diameter:	1"
Torsion shaft length required:	4.5" beyond outer track edge
Side clearance required:	5" min for motor only
Replacement red motor P/N	600816
Replacement belt size	8825-B AX25.5 8825-C AX27 8825-D AX29

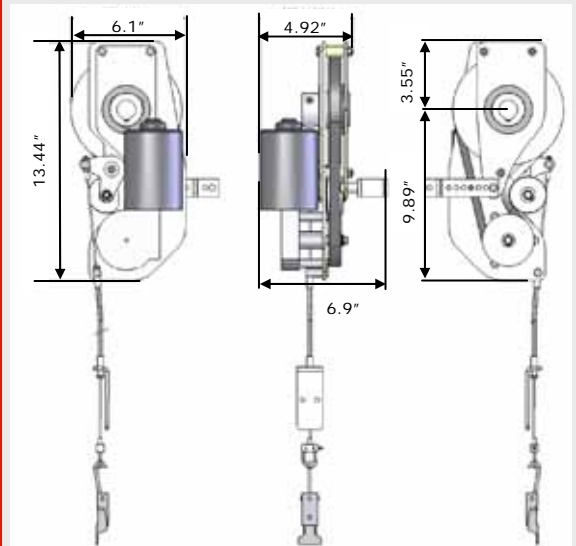

8825 II US

ZAP Series II
Simply Logical

Not For Use In Residential Applications

ZAP Controls
100 Waterloo Blvd. Anglesey Business Park, Littleworth Road, Cannock, Staffordshire, England
UK Office Number 011-44-154-387-9444 sales@zap-uk.com
Online www.zap-uk.com

ZAP Controls

8825 Series II Super-Drive

Commercial DC Sectional Door Operator

Lift	Low Head Standard	High Lift 54"	to High Lift above 54"	Vertical Lift
Door Size W X H				
8'-14'W X 8'6"-14' H	8825-II-B	8825-II-B	8825-II-C	8825-II-D
14'-20'W X 8'6"-12'H	8825-II-B	8825-II-B	8825-II-C	8825-II-D
20'-24'W X 8'6"-10'H	8825-II-B	8825-II-B	8825-II-C	8825-II-D

Sectional Doors only
Please read the instructions fully or attend training online before installation. Consult factory for door sizes beyond scope provided above. The maximum door weight for sizes listed above is 1200 Lbs. The minimum door height 8'6".

Standard Features

- Motor and controller**
Continuous duty rated DC Motor with controller, producing a powerful soft start/soft stop output of 1300 Newtons of force to drive commercial rolling sheet doors while reducing mechanical impacts that cause premature wear of door components.
- Drive reduction**
Worm drive gearbox & V-belt reduction drive with floor level, adjustable belt tensioning /emergency release lever.
- Bearings and belts**
Drive systems use industrial grade bearings and automotive grade long life v-belts. Our simplistic service design concept allows simple service of components in a matter of moments.
- Construction**
Heavy-duty 8-gauge electro-plate finish steel frame, industrial bearings, phosphor bronze worm drive gears, aluminum drive pulley, secured with key stock and set screw for simple servicing.
- Push button station**
Control unit acts as the standard 3-button station for open/close/stop functions. Controller may mounted remotely up to 24 feet away from the operator, provided it is to be wired with other external control devices that are designed to function as the primary door controls. Power supply is wired directly to the controller not the motor. Low voltage motor cable is supplied for easy wiring of the motor.

Value Added Standard Features

- Automatic obstruction sensing system**
Inherent motor current sensing system monitors the entire door system for obstructions and unsafe operating conditions in both directions of travel. The system provides protections unavailable with traditional commercial operators and can automatically sense obstructions like locks, broken springs, unsafe service conditions, and other obstructions that cannot be detected by reversing edges and photo cells.
- Safety stop and reverse**
Inherent motor current sensing system automatically incorporates and safety stop before reopening in soft start.
- Auto-close timer**
Fully programmable auto-close timer automatically closes the door. (4 minutes) Requires the addition of approved photo cell.
- Part open programming (Programmable mid stop)**
Programmable part open to stop door at predetermined height.
- Prevent door operation interlock**
Built in interlock to prevent door operation, used with truck restraint systems, shared track applications or pass doors.
- Max run time protection**
Inherent motor current sensing system provides automatic max runtime protection.
- Service due reminder**
May be activated to ensure regularly scheduled maintenance based on cycles of usage.

- Emergency egress manual operation**
Emergency manual operation using a ground level over-ride lever disconnect. When lever is released, the door will operate manually by hand as if no operator is connected to the door. This unique system eliminates the need to electrically interlock the disconnect as the operator has no mechanical limits and physically disconnects from all drive systems when released. It also provides ground level adjustment of the motor drive belt.

- Versatile mounting configurations**
8825-II may be mounted in standard vertical, horizontal, inverted, inverted center mount inside the cable drum, or rear mount torsion configurations. Some applications may require the use of a longer Bowden cable for proper installation.

Options and Accessories

- Through Beam and Retro-reflective Photo Eyes**
401001 through beam commercial grade 4 wire photo eye
401000 retro-reflective commercial grade 4 wire photo eye
- Receivers and transmitters**
2, 4, and 6 button handheld and permanently mounted forklift transmitters are available for use with the model 840 receiver. The 840 receiver module can use either an internal or optional external antenna.
- Auto-Lock**
8070 Auto-Lock provides integrated security with an electronic solenoid locking system that releases a shoot bolt above a roller when door is stopped and withdraws prior to door operation.
- Rear mount torsion kit**
ZA0102 Bowden cable. 900005 Large offset torque arm.
- Battery back up**
8830 Battery Back up systems allows operation of the operator during power outages.

Available Plug-in Modules

- Auxiliary Input Expansion Module**
871 module allows for expansion of input functions and the application of external radio receivers from other manufacturers
- Fire station module**
871 FS allows the incorporation of a second set of photo cells above man traffic height that will prevent the auto-close timer from timing out and closing a door boor before the vehicle has departed the facility. Once the vehicle has departed the opening fully, the timer is released.
- Dock interlock/Traffic light control w/adv. warning**
82DTLM and the 822 Modules provide a N/O relay that closes when the door operator is in the fully opened position. It may be used as a dock interlock or to interlock a door that shares the same track system. Provides terminals to operate red/green driver communication lighting where mechanical dock levelers are used. 822 module provides advance warning of pending door closure with activation of the delay close programming. Terminals provided on 82DTLM may also be used to operate security, heating or other 5V to 240V devices up to 5 amps. Expansion port included for the addition of 8070 Auto-Lock, 871 FS, or 871 interface expansion modules.
- Closed interlock/Traffic light control w/adv. warning**
82TLM and the 821 Modules provide a N/O relay that closes when the door operator is in the fully closed position. It may be used as a sally port interlock or to interlock any device that requires the door to be in the closed position. Provides terminals to operate red/green through traffic lights where it is desired to know the door is fully opened before proceeding through. 821 module provides advance warning of pending door closure with activation of the delay close programming. Terminals provided may also be used to operate security, heating or other 5V to 240V devices up to 5 amps. Expansion port is included for the addition of 8070 Auto-Lock, 871 FS, or 871 input expansion modules.
- Loop detectors**
Both single, and twin loop detectors are available for either plug in or wall mount installation.

ZAP Controls

8826 Series II Super Drive

Safety

- Compact size reduces potential for lifting injuries during installation
- Universal torsion shaft mounting system reduces the potential for unsafe work practices during installation
- Fully adjustable automatic obstruction sensing system detects obstructions on any part of the door in the open or close direction while monitoring the entire door movement for unsafe operation or service conditions
- Inherent soft start-soft stop, safety stop-reverse eliminates the mechanical stress damage to the door when the door reverses
- Self determining limit system prevents thrown cables from debris, ice, and snow left in the door opening
- Self engaging chain hoist when operator emergency release is lifted

Value

- Continuous duty rated low voltage motor
- Ultra-Quiet DC Motor, will not thermally overload
- Built in Service Due reminder may be activated to ensure regular maintenance based on cycles of usage
- Fully programmable Timer-to-close
- Built in interlock terminals to prevent door operation
- Programmable mid-stop
- Motor maximum amperage draw 3.2 Amps reducing number circuits required for multiple door applications
- Automatic obstruction sensing system surpasses the capabilities of a sensing edge detecting obstructions on any part of the door, eliminating the cost of a safety edge and associated wiring
- Reduces the occurrence of catastrophic damage to the door

Simplicity

- Simple one person installation that eliminate steel build ups, back hangs, welding, and specialty anchors
- Simplistic maintenance design concept
- PCB based system controller eliminates the cost of servicing electrical contactors, limit systems, and countless other parts
- When the operator emergency release lever is disengaged the door easily operates by hand
- Operates all lifts of sectional doors with counter-weights or torsion springs, including rear mount torsion
- Versatile sectional door application mounting. May be mounted vertically in either a left hand or right hand configuration without requiring wall or ceiling mount
- Simple wiring configurations and accessory modules that eliminate external limit relays to achieve various interlock configurations

Reliability

- Industrial components ensure years of service
- Long life phosphor bronze worm drive gear system
- DC Motor and controller eliminates the problem of stuck motor switches, limit system failures, burned out starting capacitors and A/C motor malfunctions

ZAP Series II Simply Logical

Not For Use In Residential Applications

ZAP Controls
100 Waterloo Blvd. Anglesey Business Park, Littleworth Road, Cannock, Staffordshire, England
UK Office Number 011-44-154-387-9444 sales@zap-uk.com
Online www.zap-uk.com



ZAP Controls
8826 Series II Super-Drive
Torsion Shaft Mounted DC Chain Hoist Commercial Sectional Door Operator

Technical information for the 8826 Series II

Controller dimensions:	6.5" H X 8.7" W X 4.7" D
Single phase voltage:	115V US, 208-230V US, 230V EU
Three phase voltage:	480V US (Special order) 8825(X)-3-480
Amp draw:	3.2A
Power rating:	1300 Newtons Equivalent to 1 HP
Control circuit voltage:	6VDC
Limits determination:	Physical/Self Calibrating
Duty cycle rating:	Continuous
Operating temp range:	-20 deg F to 212 deg F
Overload protection:	Inherent motor current sensing
Lubrication:	Permanent
Torsion shaft type required:	Solid w/keyway or hollow tube
Fits torsion shafts diameter:	1"
Torsion shaft length required:	4.5" beyond outer track edge
Side clearance required:	7" min for motor only
Replacement red motor P/N	600816
Replacement belt size:	8826-B 600611 (AX26) 8826-C 600616 (AX28) 8826-D 600603 (AX30)

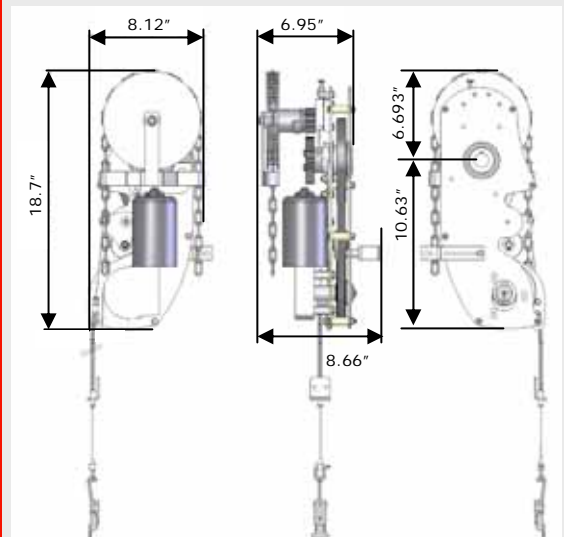

ZAP Controls

8826 Series II Super-Drive

Chain Hoist DC Sectional Door Operator

Lift	Low Head Standard	High Lift to 54"	High Lift above 54"	Vertical Lift
Door Size W X H				
8'-14"W X 8'6"-14' H	8826-II-B	8826-II-B	8826-II-C	8826-II-D
14'-20"W X 8'6"-12'H	8826-II-B	8826-II-B	8826-II-C	8826-II-D
20'-24"W X 8'6"-10'H	8826-II-B	8826-II-B	8826-II-C	8826-II-D

Sectional Doors only
Please read the instructions fully or attend training online before installation.
Consult factory for door sizes beyond scope provided above.
The maximum door weight for sizes listed above is 1200 Lbs. The minimum door height 8'6".

Standard Features

- Motor and controller**
Continuous duty rated DC Motor with controller, producing a powerful soft start/soft stop output of 1300 Newtons of force to drive commercial sectional doors while reducing mechanical impacts that cause premature wear of door components.
- Drive reduction**
Worm drive gearbox & V-belt reduction drive with floor level, adjustable Belt tensioning /emergency release lever.
- Bearings and belts**
Drive systems use industrial grade bearings and automotive grade long life v-belts. Our simplistic service design concept allows simple service of components in a matter of moments.
- Construction**
Heavy-duty 8-gauge electro-plate finish steel frame, industrial bearings, phosphor bronze worm drive gears, aluminum drive pulley, secured with key stock and set screw for simple servicing.
- Push button station**
Control unit acts as the standard 3-button station for open/close/stop functions. Controller may mounted remotely up to 24 feet away from the operator, provided it is to be wired with other external control devices that are designed to function as the primary door controls. Power supply is wired directly to the controller not the motor. Low voltage motor cable is supplied for easy wiring of the motor.
- Chain hoist**
Self engaging chain hoist when operator emergency release is lifted.

Value Added Standard Features

- Automatic Obstruction Sensing System**
Inherent motor current sensing system monitors the entire door system for obstructions and unsafe operating conditions in both directions of travel. The system provides protections unavailable with traditional commercial operators and can automatically sense obstructions like locks, broken springs, unsafe service conditions, and other obstructions that cannot be detected by reversing edges and photo cells.
- Safety stop and reverse**
Inherent motor current sensing system automatically incorporates and safety stop before reopening in soft start.
- Auto-close timer**
Fully programmable auto-close timer automatically closes the door. (4 minutes) Requires the addition of approved photo cell.
- Part open programming (Programmable mid stop)**
Programmable part open to stop door at predetermined height.
- Prevent door operation interlock**
Built in interlock to prevent door operation, used with truck restraint systems, shared track applications or pass doors.
- Max run time protection**
Inherent motor current sensing system provides automatic max runtime protection.

- Emergency egress manual operation**
Emergency manual operation using a ground level over-ride lever disconnect. When lever is released, the door will operate manually by hand as if no operator is connected to the door. This unique system eliminates the need to electrically interlock the disconnect as the operator has no mechanical limits and physically disconnects from all drive systems when released. It also provides ground level adjustment of the motor drive belt.
- Service due reminder**
May be activated to ensure regularly scheduled maintenance based on cycles of usage.
- Versatile mounting configurations**
8826-II may be mounted in vertically in either a left hand or right hand configuration.

Options and Accessories

- Through Beam and Retro-reflective Photo Eyes**
401001 through beam commercial grade 4 wire photo eye
401000 retro-reflective commercial grade 4 wire photo eye
- Receivers and transmitters**
2, 4, and 6 button handheld and permanently mounted forklift transmitters are available for use with the model 840 receiver. The 840 receiver module can use either an internal or optional external antenna.
- Auto-lock**
8070 Auto-Lock provides integrated security with an electronic solenoid locking system that releases a shoot bolt above a roller when door is stopped and withdraws prior to door operation.
- Battery back up**
8830 Battery Back up systems allows operation of the operator during power outages.

Available Plug-in Modules

- Auxiliary Input Expansion Module**
871 module allows for expansion of input functions and the application of external radio receivers from other manufacturers
- Fire Station module**
871 FS allows the incorporation of a second set of photo cells above man traffic height that will prevent the auto-close timer from timing out and closing a door before the vehicle has departed the facility. Once the vehicle has departed the opening fully, the timer is released.
- Dock interlock/Traffic light control w/adv. warning**
82DTLM and the 822 Modules provide a N/O relay that closes when the door operator is in the fully opened position. It may be used as a dock interlock or to interlock a door that shares the same track system. Provides terminals to operate red/green driver communication lighting where mechanical dock levelers are used. 822 module provides advance warning of pending door closure with activation of the delay close programming. Terminals provided on 82DTLM may also be used to operate security, heating or other 5V to 240V devices up to 5 amps. Expansion port included for the addition of 8070 Auto-Lock, 871 FS, or 871 interface expansion modules.
- Closed interlock/Traffic light control w/adv. warning**
82TLM and the 821 Modules provide a N/O relay that closes when the door operator is in the fully closed position. It may be used as a sally port interlock or to interlock any device that requires the door to be in the closed position. Provides terminals to operate red/green through traffic lights where it is desired to know the door is fully opened before proceeding through. 821 module provides advance warning of pending door closure with activation of the delay close programming. Terminals provided may also be used to operate security, heating or other 5V to 240V devices up to 5 amps. Expansion port is included for the addition of 8070 Auto-Lock, 871 FS, or 871 input expansion modules.
- Loop detectors**
Both single, and twin loop detectors are available for either plug in or wall mount installation.

ZAP Controls

8825-HPB Series II Super Drive

Safety

- Compact size reduces potential for lifting injuries during installation
- Universal torsion shaft mounting system reduces the potential for unsafe work practices during installation
- Fully adjustable automatic obstruction sensing system detects obstructions on any part of the door in the open or close direction while monitoring the entire door movement for unsafe operation or service conditions
- Inherent soft start-soft stop, safety stop-reverse eliminates the mechanical stress damage to the door when the door reverses
- Self determining limit system prevents thrown cables from debris, ice, and snow left in the door opening

Value

- Continuous duty rated low voltage motor
- Ultra-Quiet DC Motor, will not thermally overload
- Built in Service Due reminder may be activated to ensure regular maintenance based on cycles of usage
- Fully programmable Timer-to-close
- Built in interlock terminals to prevent door operation
- Programmable mid-stop
- Motor maximum amperage draw 5.8 Amps reducing number circuits required for multiple door applications
- Automatic obstruction sensing system surpasses the capabilities of a sensing edge detecting obstructions on any part of the door, eliminating the cost of a safety edge and associated wiring
- Reduces the occurrence of catastrophic damage to the door

Simplicity

- Simple one person installation that eliminate steel build ups, back hangs, welding, and specialty anchors
- Simplistic maintenance design concept
- PCB based system controller eliminates the cost of servicing electrical contactors, limit systems, and countless other parts
- When the operator emergency release lever is disengaged the door easily operates by hand
- Operates all lifts of sectional doors with counter-weights or torsion springs, including rear mount torsion
- Versatile sectional door application mounting. May be mounted vertically, horizontally, upside down, inside the cable drum, rear mount torsion, all without requiring wall or ceiling mount
- Simple wiring configurations and accessory modules that eliminate external limit relays to achieve various interlock configurations

Reliability

- Industrial components ensure years of service
- Long life phosphor bronze worm drive gear system
- DC Motor and controller eliminates the problem of stuck motor switches, limit system failures, burned out starting capacitors and A/C motor malfunctions



ZAP Controls
8825-HPB Series II Super-Drive
Torsion Shaft Mounted DC Commercial Sectional Door Operator

Technical information for the 8825 HP B Series II

Controller dimensions:	8.7" H X 10.6" W X 4.5D
Single phase voltage:	115V US, 208-230V US, 230V EU
Amp draw:	5.8A
Power rating:	2000 Newtons Equivalent 1.5 HP
Control circuit voltage:	6VDC
Limits determination:	Physical/Self Calibrating
Duty cycle rating:	Continuous
Operating temp range:	-20 deg F to 212 deg F
Overload protection:	Inherent motor current sensing
Lubrication:	Permanent
Torsion shaft type required:	Solid w/keyway or hollow tube
Fits torsion shafts diameter:	1"
Torsion shaft length required:	4.5" beyond outer track edge
Side clearance required:	5.5" min for motor only
Replacement red motor P/N	600814
Replacement belt size	8825-HPB 600617 (AX29)

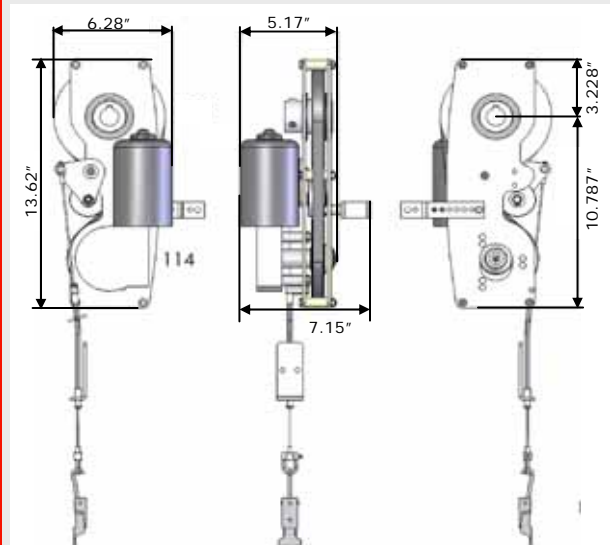

8825 II HPB US

ZAP Series II

Not For Use In Residential Applications

Simply Logical

ZAP Controls
100 Waterloo Blvd. Anglesey Business Park, Littleworth Road, Cannock, Staffordshire, England
UK Office Number 011-44-154-387-9444 sales@zap-uk.com
Online www.zap-uk.com

ZAP Controls

8825-HPB Series II Super-Drive

Commercial DC Sectional Door Operator

Lift Requirement	Low Headroom	Standard Lift	High Lift to 54"	High Lift above 54"	Vertical Lift
Door Size W X H					
10'-24"W X 8'-12"H	8825-II-HPB	8825-II-HPB	8825-II-HPB	8825-II-HPB	8825-II-HPB
10'-20"W X 12'-15"H	8825-II-HPB	8825-II-HPB	8825-II-HPB	See 8825-II-HPC	See 8825-II-HPD
Please read the instructions fully or attend training online before installation. Consult factory for door sizes beyond scope provided above. The maximum door weight for sizes listed above is 1800 Lbs. The minimum door height 8'6".					

Standard Features

- Motor and controller**
 Continuous duty rated DC Motor with controller, producing a powerful soft start/soft stop output of 2000 Newtons of force to drive commercial sectional doors while reducing mechanical impacts that cause premature wear of door components.
- Drive reduction**
 Worm drive gearbox & V-belt reduction drive with floor level, adjustable belt tensioning /emergency release lever.
- Bearings and belts**
 Drive systems use industrial grade bearings and automotive grade long life v-belts. Our simplistic service design concept allows simple service of components in a matter of moments.
- Construction**
 Heavy-duty 8-gauge electro-plate finish steel frame, industrial bearings, phosphor bronze worm drive gears, aluminum drive pulley, secured with key stock and setscrew for simple servicing.
- Push button station**
 Control unit acts as the standard 3-button station for open/close/stop functions. Controller may mounted remotely up to 24 feet away from the operator, provided it is to be wired with other external control devices that are designed to function as the primary door controls. Power supply is wired directly to the controller not the motor. Low voltage motor cable is supplied for easy wiring.

Value Added Standard Features

- Automatic obstruction sensing system**
 Inherent motor current sensing system monitors the entire door system for obstructions and unsafe operating conditions in both directions of travel. The system provides protections unavailable with traditional commercial operators and can automatically sense obstructions like locks, broken springs, unsafe service conditions, and other obstructions that cannot be detected by reversing edges and photo cells.
- Safety stop and reverse**
 Inherent motor current sensing system automatically incorporates and safety stop before reopening in soft start.
- Auto-close timer**
 Fully programmable auto-close timer automatically closes the door. (4 minutes) Requires the addition of approved photo cell.
- Part open programming (Programmable mid stop)**
 Programmable part open to stop door at predetermined height.
- Prevent door operation interlock**
 Built in interlock to prevent door operation, used with truck restraint systems, shared track applications or pass doors.
- Max run time protection**
 Inherent motor current sensing system provides automatic max runtime protection.
- Service due reminder**
 May be activated to ensure regularly scheduled maintenance based on cycles of usage.

- Emergency egress manual operation**
 Emergency manual operation using a ground level over-ride lever disconnect. When lever is released, the door will operate manually by hand as if no operator is connected to the door. This unique system eliminates the need to electrically interlock the disconnect as the operator has no mechanical limits and physically disconnects from all drive systems when released. It also provides ground level adjustment of the motor drive belt.
- Versatile mounting configurations**
 8825-II-HPB may be mounted in standard vertical, horizontal, inverted, inverted center mount inside the cable drum, or rear mount torsion configurations. Some applications may require the use of a longer Bowden cable for proper installation.

Options and Accessories

- Through Beam and Retro-reflective Photo Eyes**
 401001 through beam commercial grade 4 wire photo eye
 401000 retro-reflective commercial grade 4 wire photo eye
- Receivers and transmitters**
 2, 4, and 6 button handheld and permanently mounted forklift transmitters are available for use with the model 840 receiver. The 840 receiver module can use either an internal or optional external antenna.
- Auto-lock**
 8070 Auto-Lock provides integrated security with an electronic solenoid locking system that releases a shoot bolt above a roller when door is stopped and withdraws prior to door operation.
- Rear mount torsion kit**
 ZA0102 Bowden cable. 900005 Large offset torque arm.
- Battery back up**
 8830 Battery Back up systems allows operation of the operator during power outages.

Available Plug-in Modules

- Auxiliary Input Expansion Module**
 871 module allows for expansion of input functions and the application of external radio receivers from other manufacturers
- Fire station module**
 871 FS allows the incorporation of a second set of photo cells above man traffic height that will prevent the auto-close timer from timing out and closing a door boor before the vehicle has departed the facility. Once the vehicle has departed the opening fully, the timer is released.
- Dock interlock/Traffic light control w/adv. warning**
 82DTLM and the 822 Modules provide a N/O relay that closes when the door operator is in the fully opened position. It may be used as a dock interlock or to interlock a door that shares the same track system. Provides terminals to operate red/green driver communication lighting where mechanical dock levelers are used. 822 module provides advance warning of pending door closure with activation of the delay close programming. Terminals provided on 82DTLM may also be used to operate security, heating or other 5V to 240V devices up to 5 amps. Expansion port included for the addition of 8070 Auto-Lock, 871 FS, or 871 interface expansion modules.
- Closed interlock/Traffic light control w/adv. warning**
 82TLM and the 821 Modules provide a N/O relay that closes when the door operator is in the fully closed position. It may be used as a sally port interlock or to interlock any device that requires the door to be in the closed position. Provides terminals to operate red/green through traffic lights where it is desired to know the door is fully opened before proceeding through. 821 module provides advance warning of pending door closure with activation of the delay close programming. Terminals provided may also be used to operate security, heating or other 5V to 240V devices up to 5 amps. Expansion port is included for the addition of 8070 Auto-Lock, 871 FS, or 871 input expansion modules.
- Loop detectors**
 Both single, and twin loop detectors are available for either plug in or wall mount installation.

ZAP Controls

8825-HPC/D Series II Super Drive

Safety

- Compact size reduces potential for lifting injuries during installation
- Universal torsion shaft mounting system reduces the potential for unsafe work practices during installation
- Fully adjustable automatic obstruction sensing system detects obstructions on any part of the door in the open or close direction while monitoring the entire door movement for unsafe operation or service conditions
- Inherent soft start-soft stop, safety stop-reverse eliminates the mechanical stress damage to the door when the door reverses
- Self determining limit system prevents thrown cables from debris, ice, and snow left in the door opening

Value

- Continuous duty rated low voltage motor
- Ultra-Quiet DC Motor, will not thermally overload
- Built in Service Due reminder may be activated to ensure regular maintenance based on cycles of usage
- Fully programmable Timer-to-close
- Built in interlock terminals to prevent door operation
- Programmable mid-stop
- Motor maximum amperage draw 5.8 Amps reducing number circuits required for multiple door applications
- Automatic obstruction sensing system surpasses the capabilities of a sensing edge detecting obstructions on any part of the door, eliminating the cost of a safety edge and associated wiring
- Reduces the occurrence of catastrophic damage to the door

Simplicity

- Simple one person installation that eliminate steel build ups, back hangs, welding, and specialty anchors
- Simplistic maintenance design concept
- PCB based system controller eliminates the cost of servicing electrical contactors, limit systems, and countless other parts
- When the operator emergency release lever is disengaged the door easily operates by hand
- Operates all lifts of sectional doors with counter-weights or torsion springs, including rear mount torsion
- Versatile sectional door application mounting. May be mounted vertically, horizontally, upside down, inside the cable drum, rear mount torsion, all without requiring wall or ceiling mount
- Simple wiring configurations and accessory modules that eliminate external limit relays to achieve various interlock configurations

Reliability

- Industrial components ensure years of service
- Long life phosphor bronze worm drive gear system
- DC Motor and controller eliminates the problem of stuck motor switches, limit system failures, burned out starting capacitors and A/C motor malfunctions

ZAP Series II Simply Logical

Not For Use In Residential Applications

ZAP Controls
100 Waterloo Blvd. Anglesey Business Park, Littleworth Road, Cannock, Staffordshire, England
UK Office Number 011-44-154-387-9444 sales@zap-uk.com
Online www.zap-uk.com



Technical information for the 8825 HP B Series II

Controller dimensions:	8.7"HX10.6"W X4.5D
Single phase voltage:	115V US, 208-230V US, 230V EU
Amp draw:	5.8A
Power rating	2000 Newtons Equivalent 1.5 HP
Control circuit voltage:	6VDC
Limits determination:	Physical/Self Calibrating
Duty cycle rating:	Continuous
Operating temp range:	-20 deg F to 212 deg F
Overload protection:	Inherent motor current sensing
Lubrication:	Permanent
Torsion shaft type required:	Solid w/keyway or hollow tube
Fits torsion shafts diameter:	1"
Torsion shaft length required:	4.5" beyond outer track edge
Side clearance required:	5.5" min for motor only
Replacement red motor P/N	600814
Replacement belt size	8825-HPC 600621 (AX38) 8825-HPD 600621 (AX41)

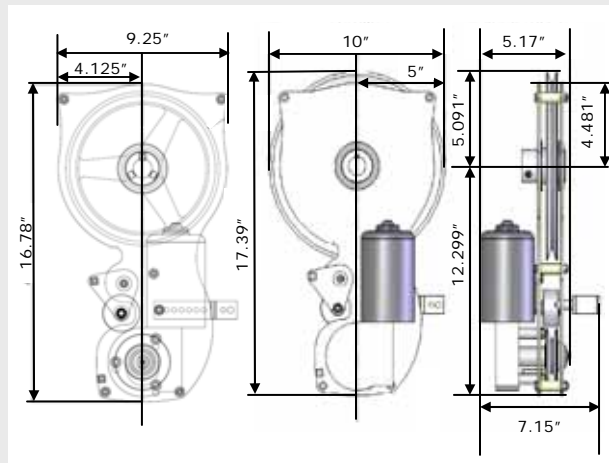

ZAP Controls
8825-HPC/D Series II Super-Drive
Torsion Shaft Mounted DC Commercial Sectional Door Operator

ZAP Controls

8825-HPC/D Series II Super-Drive

Commercial DC Sectional Door Operator

Lift Requirement	Low Headroom	Standard Lift	High Lift to 54"	High Lift above 54"	Vertical Lift
Door Size W X H					
10'-24'W X 16'-20'H	8825-II-HPC	8825-II-HPC	8825-II-HPC	8825-II-HPD	8825-II-HPD
Please read the instructions fully or attend training online before installation. Consult factory for door sizes beyond scope provided above. Operators are pre configured to accept 1.25" shaft. For 1" shafts order adapter insert PN ZA0191 The maximum door weight for sizes listed above is 1800 Lbs. The minimum door height 9'6".					

Standard Features

- Motor and controller**
 Continuous duty rated DC Motor with controller, producing a powerful soft start/soft stop output of 2000 Newtons of force to drive commercial sectional doors while reducing mechanical impacts that cause premature wear of door components.
- Drive reduction**
 Worm drive gearbox & V-belt reduction drive with floor level, adjustable belt tensioning /emergency release lever.
- Bearings and belts**
 Drive systems use industrial grade bearings and automotive grade long life v-belts. Our simplistic service design concept allows simple service of components in a matter of moments.
- Construction**
 Heavy-duty 8-gauge electro-plate finish steel frame, industrial bearings, phosphor bronze worm drive gears, aluminum drive pulley, secured with key stock and set screw for simple servicing.
- Push button station**
 Control unit acts as the standard 3-button station for open/close/stop functions. Controller may mounted remotely up to 24 feet away from the operator, provided it is to be wired with other external control devices that are designed to function as the primary door controls. Power supply is wired directly to the controller not the motor. Low voltage motor cable is supplied for easy wiring.

Value Added Standard Features

- Automatic obstruction sensing system**
 Inherent motor current sensing system monitors the entire door system for obstructions and unsafe operating conditions in both directions of travel. The system provides protections unavailable with traditional commercial operators and can automatically sense obstructions like locks, broken springs, unsafe service conditions, and other obstructions that cannot be detected by reversing edges and photo cells.
- Safety stop and reverse**
 Inherent motor current sensing system automatically incorporates and safety stop before reopening in soft start.
- Auto-close timer**
 Fully programmable auto-close timer automatically closes the door. (4 minutes) Requires the addition of approved photo cell.
- Part open programming (Programmable mid stop)**
 Programmable part open to stop door at predetermined height.
- Prevent door operation interlock**
 Built in interlock to prevent door operation, used with truck restraint systems, shared track applications or pass doors.
- Max run time protection**
 Inherent motor current sensing system provides automatic max runtime protection.
- Service due reminder**
 May be activated to ensure regularly scheduled maintenance based on cycles of usage.

- Emergency egress manual operation**
 Emergency manual operation using a ground level over-ride lever disconnect. When lever is released, the door will operate manually by hand as if no operator is connected to the door. This unique system eliminates the need to electrically interlock the disconnect as the operator has no mechanical limits and physically disconnects from all drive systems when released. It also provides ground level adjustment of the motor drive belt.
- Versatile mounting configurations**
 8825-II-HPC/D may be mounted in standard vertical, horizontal, inverted, inverted center mount inside the cable drum, or rear mount torsion configurations. Some applications may require the use of a longer Bowden cable for proper installation.

Options and Accessories

- Through Beam and Retro-reflective Photo Eyes**
 401001 through beam commercial grade 4 wire photo eye
 401000 retro-reflective commercial grade 4 wire photo eye
- Receivers and transmitters**
 2, 4, and 6 button handheld and permanently mounted forklift transmitters are available for use with the model 840 receiver. The 840 receiver module can use either an internal or optional external antenna.
- Auto-lock**
 8070 Auto-Lock provides integrated security with an electronic solenoid locking system that releases a shoot bolt above a roller when door is stopped and withdraws prior to door operation.
- Rear mount torsion kit**
 ZA102 Bowden cable. 900005 Large offset torque arm.
- Battery back up**
 8830 Battery Back up systems allows operation of the operator during power outages.
- Adapter insert**
 ZA0191 Adapter insert for converting operator to accept 1" dead axle shafts.

Available Plug-in Modules

- Auxiliary Input Expansion Module**
 871 module allows for expansion of input functions and the application of external radio receivers from other manufacturers
- Fire station module**
 871 FS allows the incorporation of a second set of photo cells above man traffic height that will prevent the auto-close timer from timing out and closing a door boor before the vehicle has departed the facility. Once the vehicle has departed the opening fully, the timer is released.
- Dock interlock/Traffic light control w/adv. warning**
 82DTLM and the 822 Modules provide a N/O relay that closes when the door operator is in the fully opened position. It may be used as a dock interlock or to interlock a door that shares the same track system. Provides terminals to operate red/green driver communication lighting where mechanical dock levelers are used. 822 module provides advance warning of pending door closure with activation of the delay close programming. Terminals provided on 82DTLM may also be used to operate security, heating or other 5V to 240V devices up to 5 amps. Expansion port included for the addition of 8070 Auto-Lock, 871 FS, or 871 interface expansion modules.
- Closed interlock/Traffic light control w/adv. warning**
 82TLM and the 821 Modules provide a N/O relay that closes when the door operator is in the fully closed position. It may be used as a sally port interlock or to interlock any device that requires the door to be in the closed position. Provides terminals to operate red/green through traffic lights where it is desired to know the door is fully opened before proceeding through. 821 module provides advance warning of pending door closure with activation of the delay close programming. Terminals provided may also be used to operate security, heating or other 5V to 240V devices up to 5 amps. Expansion port is included for the addition of 8070 Auto-Lock, 871 FS, or 871 input expansion modules.
- Loop detectors**
 Both single, and twin loop detectors are available for either plug in or wall mount installation.

ZAP Controls

8855 Turbo Drive High Speed Operator

Speed

- Achieves speed of up to 91.44cm per second on high lift and vertical lift sectional doors without mechanical impact to the door.

Safety

- Compact size reduces potential for lifting injuries during installation
- Universal torsion shaft mounting system reduces the potential for unsafe work practices during installation
- Fully adjustable automatic obstruction sensing system detects obstructions on any part of the door in the open or close direction while monitoring the entire door movement for unsafe operation or service conditions
- Inherent soft start-soft stop, safety stop-reverse eliminates the mechanical stress damage to the door when the door reverses
- Self determining limit system prevents thrown cables from debris, ice, and snow left in the door opening

Value

- Continuous duty rated low voltage motor
- Ultra-Quiet DC Motor, will not thermally overload
- Built in Service Due reminder may be activated to ensure regular maintenance based on cycles of usage
- Fully programmable Timer-to-close
- Motor maximum amperage draw 5.8 Amps reducing number circuits required for multiple door applications
- Automatic obstruction sensing system surpasses the capabilities of a sensing edge detecting obstructions on any part of the door, eliminating the cost of a safety edge and associated wiring
- Reduces the occurrence of catastrophic damage to the door

Simplicity

- Simple one person installation that eliminate steel build ups, back hangs, welding, and specialty anchors
- Simplistic maintenance design concept
- PCB based system controller eliminates the cost of servicing electrical contactors, limit systems, and countless other parts
- When the operator emergency release lever is disengaged the door easily operates by hand
- Operates all lifts of sectional doors with counter-weights or torsion springs, including rear mount torsion
- Versatile sectional door application mounting. May be mounted vertically, horizontally, upside down, inside the cable drum, rear mount torsion, all without requiring wall or ceiling mount
- Simple wiring configurations and accessory modules that eliminate external limit relays to achieve various interlock configurations

Reliability

- Industrial components ensure years of service
- Long life phosphor bronze worm drive gear system
- DC Motor and controller eliminates the problem of stuck motor switches, limit system failures, burned out starting capacitors and A/C motor malfunctions

ZAP Series II

Simply Logical

Not For Use In Residential Applications

ZAP Controls
100 Waterloo Blvd. Anglesey Business Park, Littleworth Road, Cannock, Staffordshire, England
UK Office Number 011-44-154-387-9444 sales@zap-uk.com
Online www.zap-uk.com



ZAP Controls
8855 Turbo Drive High Speed Operator
Torsion Shaft Mounted DC Commercial Sectional Door Operator

Technical information for the 8855 Turbo Drive

Controller dimensions:	8.7" H X 10.6" W X 4.5D
Single phase voltage:	115V US, 208-230V US, 230V EU
Amp draw:	7A
Power rating:	2000 Newtons Equivalent 1.5 HP
Control circuit voltage:	6VDC
Limits determination:	Physical/Self Calibrating
Duty cycle rating:	Continuous
Operating temp range:	-20 deg F to 212 deg F
Overload protection:	Inherent motor current sensing
Lubrication:	Permanent
Torsion shaft type required:	Solid w/keyway
Fits torsion shafts diameter:	1"
Torsion shaft length required:	4.5" beyond outer track edge
Side clearance required:	5.5" min for motor only
Replacement belt size	8855-A 600614 (AX27) 8855-B 600617 (AX29) 8855-C 600603 (AX30) 8855-D 600607 (AX31.5)

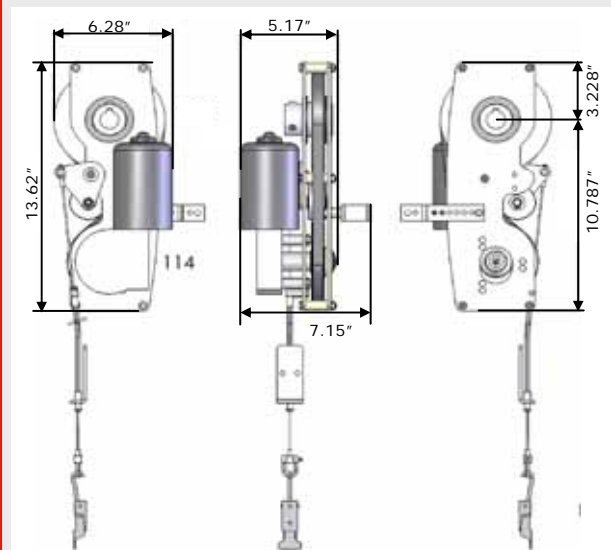

ZAP Controls

8855 Turbo Drive

Commercial DC Sectional Door Operator

Lift Requirement	Standard Lift	High Lift to 54"	High Lift above 54"	Vertical lift
Drum Diameter>>	Drum Dia <6"	Drum Dia >6" up to 8"	Drum Dia > 8"	Drum Dia >10"
Operator Size A		26" per Second	36" per Second	36" per Second
Operator Size B		20" per Second	27" per Second	27" per Second
Operator Size C		15" per Second	21" per Second	21" per Second
Operator Size D		11" per Second	18" per Second	18" per Second
8'-16" W X 9' H	8855-C	Select Pulley for required Speed		
8'-14" W X 10' H	8855-D	8855-A/B/C/D		
8'-12" W X 12' H	8855-D	8855-A/B/C/D		
8'-10" W X 14' H	8855-D	8855-A/B/C/D		
8'-9" W X 15' H	8855-D	8855-A/B/C/D		
Read instructions fully or attend training online before installation.				
Recommend mounting to solid torsion shafts only. Requires 5" of torsion shaft exposed beyond track edge				
Operator Max door weight capacity is 600lbs. The Lighter the door the better the performance.				
Low voltage wiring to motor provided.				

Standard Features

- Standard or Fire Station model**
 The 8855-STD provides normal high speed operation for through traffic or ramp doors, while the 8855-FS Fire Station model allows the incorporation of a second set of photo cells to be installed above man traffic height that will prevent the auto-close timer from timing out and closing a door boor before the vehicle has departed the facility. Once the vehicle has departed the opening fully, the timer is released. Note: the 8855FS should not be used without the incorporation of the auto close timer
- Motor and controller**
 Continuous duty rated DC Motor with controller, producing a powerful soft start/soft stop output of 2000 Newtons of force to drive commercial sectional doors while reducing mechanical impacts that cause premature wear of door components.
- Drive reduction**
 Worm drive gearbox & V-belt reduction drive with floor level, adjustable belt tensioning /emergency release lever.
- Bearings and belts**
 Drive systems use industrial grade bearings and automotive grade long life v-belts. Our simplistic service design concept allows simple service of components in a matter of moments.
- Construction**
 Heavy-duty 8-gauge electro-plate finish steel frame, industrial bearings, phosphor bronze worm drive gears, aluminum drive pulley, secured with key stock and set screw for simple servicing.
- Push button station**
 Control unit acts as the standard 3-button station for open/close/stop functions. Controller may mounted remotely up to 24 feet away from the operator, provided it is to be wired with other external control devices that are designed to function as the primary door controls. Power supply is wired directly to the controller not the motor. Low voltage motor cable is supplied for easy wiring.

Value Added Standard Features

- Automatic obstruction sensing system**
 Inherent motor current sensing system monitors the entire door system for obstructions and unsafe operating conditions in both directions of travel. The system provides protections unavailable with traditional commercial operators and can automatically sense obstructions like locks, broken springs, unsafe service conditions, and other obstructions that cannot be detected by reversing edges and photo cells.
- Safety stop and reverse**
 Inherent motor current sensing system automatically incorporates and safety stop before reopening in soft start.
- Auto-close timer**
 Fully programmable auto-close timer automatically closes the door. (4 minutes) Requires the addition of approved photo cell.
- Prevent door operation interlock**
 Built in interlock to prevent door operation, used with truck restraint systems, shared track applications or pass doors.

- Emergency egress manual operation**
 Emergency manual operation using a ground level over-ride lever disconnect. When lever is released, the door will operate manually by hand as if no operator is connected to the door. This unique system eliminates the need to electrically interlock the disconnect as the operator has no mechanical limits and physically disconnects from all drive systems when released. It also provides ground level adjustment of the motor drive belt.
- Max run time protection**
 Inherent motor current sensing system provides automatic max runtime protection.
- Service due reminder**
 May be activated to ensure regularly scheduled maintenance based on cycles of usage.
- Versatile mounting configurations**
 8855 may be mounted in standard vertical, horizontal, inverted, inverted center mount inside the cable drum, or rear mount torsion configurations. Some applications may require the use of a longer Bowden cable for proper installation.

Options and Accessories

- Through Beam and Retro-reflective Photo Eyes**
 401001 through beam commercial grade 4 wire photo eye
 401000 retro-reflective commercial grade 4 wire photo eye
- Receivers and transmitters**
 2, 4, and 6 button handheld and permanently mounted forklift transmitters are available for use with the model 840 receiver. The 840 receiver module can use either an internal or optional external antenna.
- Auto-lock**
 8070 Auto-Lock provides integrated security with an electronic solenoid locking system that releases a shoot bolt above a roller when door is stopped and withdraws prior to door operation.

Available Plug-in Modules

- Auxiliary Input Expansion Module**
 871 module allows for expansion of input functions and the application of external radio receivers form other manufacturers
- Dock interlock/Traffic light control w/adv. warning**
 82DTLM and the 822 Modules provide a N/O relay that closes when the door operator is in the fully opened position. It may be used as a dock interlock or to interlock a door that shares the same track system. Provides terminals to operate red/green driver communication lighting where mechanical dock levelers are used. 822 module provides advance warning of pending door closure with activation of the delay close programming. Terminals provided on 82DTLM may also be used to operate security, heating or other 5V to 240V devices up to 5 amps. Expansion port included for the addition of 8070 Auto-Lock, 871 FS, or 871 interface expansion modules.
- Closed interlock/Traffic light control w/adv. warning**
 82TLM and the 821 Modules provide a N/O relay that closes when the door operator is in the fully closed position. It may be used as a sally port interlock or to interlock any device that requires the door to be in the closed position. Provides terminals to operate red/green through traffic lights where it is desired to know the door is fully opened before proceeding through. 821 module provides advance warning of pending door closure with activation of the delay close programming. Terminals provided may also be used to operate security, heating or other 5V to 240V devices up to 5 amps. Expansion port is included for the addition of 8070 Auto-Lock, 871 FS, or 871 input expansion modules.
- Loop detectors**
 Both single, and twin loop detectors are available for either plug in or wall mount installation.

ZAP Controls

815-SL Series II Super Drive

Safety

- Compact size reduces potential for lifting injuries during installation
- Universal shaft mounting system reduces the potential for unsafe work practices during installation
- Fully adjustable automatic obstruction sensing system detects obstructions on any part of the door in the open or close direction while monitoring the entire door movement for unsafe operation or service conditions
- Inherent soft start-soft stop, safety stop-reverse eliminates the mechanical stress damage to the door when the door reverses
- Self determining limit system prevents thrown cables from debris, ice, and snow left in the door opening

Value

- Continuous duty rated low voltage motor
- Ultra-Quiet DC Motor, will not thermally overload
- Built in Service Due reminder may be activated to ensure regular maintenance based on cycles of usage
- Fully programmable Timer-to-close
- Built in interlock terminals to prevent door operation
- Programmable mid-stop
- Motor maximum amperage draw 2.8 Amps reducing number circuits required for multiple door applications
- Automatic obstruction sensing system surpasses the capabilities of a sensing edge detecting obstructions on any part of the door, eliminating the cost of a safety edge and associated wiring
- Reduces the occurrence of catastrophic damage to the door

Simplicity

- Simple one person installation that eliminate steel build ups, front of hood mounts, welding, and specialty anchors
- Simplistic maintenance design concept
- PCB based system controller eliminates the cost of servicing electrical contactors, limit systems, and countless other parts
- When the operator emergency release lever is disengaged the door easily operates by hand
- Operates both 25.4mm and 31.75mm Dead Axle Rolling Sheet Doors
- Universal Left or Right hand mounting requiring 0mm of side clearance
- Simple wiring configurations and accessory modules that eliminate external limit relays to achieve various interlock configurations

Reliability

- Industrial components ensure years of service
- DC Motor and controller eliminates the problem of stuck motor switches, limit system failures, burned out starting capacitors and A/C motor malfunctions



ZAP Controls
815-SL Series II Super-Drive
 DC Commercial Dead Axle Rolling Sheet Door Operator

Technical information for the 815-SL Series II

Controller dimensions:	6.5" H X 5.4" W X 4" D
Single phase voltage:	115V US, 208-230V US, 230V EU
Amp draw:	2.8A
Power rating:	650 Newtons Equivalent 1/2 HP
Control circuit voltage:	6VDC
Limits determination:	Physical/Self Calibrating
Duty cycle rating:	Continuous
Operating temp range:	-22 deg F to 212 deg F
Overload protection:	Inherent motor current sensing
Lubrication:	Permanent
Door axle type required:	Dead Axle
Fits Torsion shafts diameter:	1" w/adaptor PN 600249
Side clearance required:	0mm
Replacement motor PN	600805
Replacement belt PN/size	815-SL 600621 (AX38)

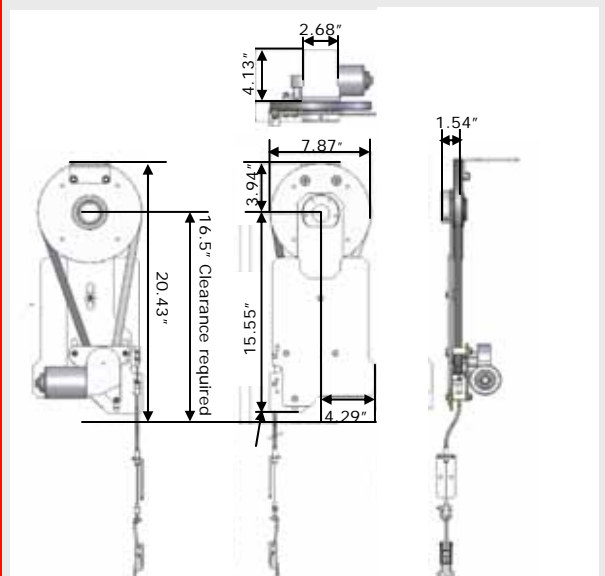

815 II SL US

ZAP Series II
Simply Logical

Not For Use In Residential Applications

ZAP Controls
 100 Waterloo Blvd. Anglesey Business Park, Littleworth Road, Cannock, Staffordshire, England
 UK Office Number 011-44-154-387-9444 sales@zap-uk.com
 Online www.zap-uk.com

ZAP Controls

815-SL Series II Super-Drive

Commercial DC Dead Axle Rolling Sheet Door Operator

Door Size W X H	
3'-12"W X 3'-5'-11"H	815-II-SL with Short run chip
3'-12"W X 6'-8"H	815-II-SL

Please read the instructions fully or attend training online before installation. Consult factory for door sizes beyond scope provided above. Mount to 1-5/16" dead axle sheet door. 1" axle using adapter. PN 600249. The minimum door height is 6'. Short run chip is available for lower heights.

Standard Features

- **Motor and controller**
Continuous duty rated DC Motor with controller, producing a powerful soft start/soft stop output of 650 Newtons of force to drive commercial rolling sheet doors while reducing mechanical impacts that cause premature wear of door components.
- **Drive reduction**
Worm drive gearbox & V-belt reduction drive with floor level, adjustable belt tensioning /emergency release lever.
- **Bearings and belts**
Drive systems use industrial grade bearings and automotive grade long life v-belts. Our simplistic service design concept allows simple service of components in a matter of moments.
- **Construction**
Heavy-duty 8-gauge electro-plate finish steel frame, industrial bearings, worm drive gear box, aluminum drive pulley, secured with key stock and setscrew for simple servicing.
- **Push button station**
Control unit acts as the standard 3-button station for open/close/stop functions. Controller may mounted remotely up to 24 feet away from the operator, provided it is to be wired with other external control devices that are designed to function as the primary door controls. Power supply is wired directly to the controller not the motor. Low voltage motor cable is supplied for easy wiring.

Value Added Standard Features

- **Automatic obstruction sensing system**
Inherent motor current sensing system monitors the entire door system for obstructions and unsafe operating conditions in both directions of travel. The system provides protections unavailable with traditional commercial operators and can automatically sense obstructions like locks, broken springs, unsafe service conditions, and other obstructions that cannot be detected by reversing edges and photo cells.
- **Safety stop and reverse**
Inherent motor current sensing system automatically incorporates and safety stop before reopening in soft start.
- **Auto-close timer**
Fully programmable auto-close timer automatically closes the door. (4 minutes) Requires the addition of approved photo cell.
- **Part open programming (Programmable mid stop)**
Programmable part open to stop door at predetermined height.
- **Prevent door operation interlock**
Built in interlock to prevent door operation, used with truck restraint systems, shared track applications or pass doors.
- **Max run time protection**
Inherent motor current sensing system provides automatic max runtime protection.
- **Service due reminder**
May be activated to ensure regularly scheduled maintenance based on cycles of usage.

- **Emergency egress manual operation**
Emergency manual operation using a ground level over-ride lever disconnect. When lever is released, the door will operate manually by hand as if no operator is connected to the door. This unique system eliminates the need to electrically interlock the disconnect as the operator has no mechanical limits and physically disconnects from all drive systems when released. It also provides ground level adjustment of the motor drive belt.
- **Versatile mounting configurations**
815 3 SL may be mounted universally in the left hand or right hand position, requiring no specialty brackets for mounting.

Options and Accessories

- **Through Beam and Retro-reflective Photo Eyes**
401001 through beam commercial grade 4 wire photo eye
401000 retro-reflective commercial grade 4 wire photo eye
- **Receivers and transmitters**
2, 4, and 6 button handheld and permanently mounted forklift transmitters are available for use with the model 840 receiver. The 840 receiver module can use either an internal or optional external antenna.
- **Battery back up**
8830 Battery Back up systems allows operation of the operator during power outages.
- **Adapter insert**
600249 Adapter insert for converting operator to accept 25.4mm dead axle shafts.

Available Plug-in Modules

- **Auxiliary Input Expansion Module**
871 module allows for expansion of input functions and the application of external radio receivers from other manufacturers
- **Fire station module**
871 FS allows the incorporation of a second set of photo cells above man traffic height that will prevent the auto-close timer from timing out and closing a door before the vehicle has departed the facility. Once the vehicle has departed the opening fully, the timer is released.
- **Dock interlock/Traffic light control w/adv. warning**
82DTLM and the 822 Modules provide a N/O relay that closes when the door operator is in the fully opened position. It may be used as a dock interlock or to interlock a door that shares the same track system. Provides terminals to operate red/green driver communication lighting where mechanical dock levelers are used. 822 module provides advance warning of pending door closure with activation of the delay close programming. Terminals provided on 82DTLM may also be used to operate security, heating or other 5V to 240V devices up to 5 amps. Expansion port included for the addition of 8070 Auto-Lock, 871 FS, or 871 interface expansion modules.
- **Closed interlock/Traffic light control w/adv. warning**
82TLM and the 821 Modules provide a N/O relay that closes when the door operator is in the fully closed position. It may be used as a sally port interlock or to interlock any device that requires the door to be in the closed position. Provides terminals to operate red/green through traffic lights where it is desired to know the door is fully opened before proceeding through. 821 module provides advance warning of pending door closure with activation of the delay close programming. Terminals provided may also be used to operate security, heating or other 5V to 240V devices up to 5 amps. Expansion port is included for the addition of 8070 Auto-Lock, 871 FS, or 871 input expansion modules.
- **Loop detectors**
Both single, and twin loop detectors are available for either plug in or wall mount installation

ZAP Controls

8815-SD Series II Super Drive

Safety

- Compact size reduces potential for lifting injuries during installation
- Universal torsion shaft mounting system reduces the potential for unsafe work practices during installation
- Fully adjustable automatic obstruction sensing system detects obstructions on any part of the door in the open or close direction while monitoring the entire door movement for unsafe operation or service conditions
- Inherent soft start-soft stop, safety stop-reverse eliminates the mechanical stress damage to the door when the door reverses
- Self determining limit system prevents thrown cables from debris, ice, and snow left in the door opening

Value

- Continuous duty rated low voltage motor
- Ultra-Quiet DC Motor, will not thermally overload
- Built in Service Due reminder may be activated to ensure regular maintenance based on cycles of usage
- Fully programmable Timer-to-close
- Built in interlock terminals to prevent door operation
- Programmable mid-stop
- Motor maximum amperage draw 3.2 Amps reducing number circuits required for multiple door applications
- Automatic obstruction sensing system surpasses the capabilities of a sensing edge detecting obstructions on any part of the door, eliminating the cost of a safety edge and associated wiring
- Reduces the occurrence of catastrophic damage to the door

Simplicity

- Simple one person installation that eliminate steel build ups, front of hood mounts, welding, and specialty anchors
- Simplistic maintenance design concept
- PCB based system controller eliminates the cost of servicing electrical contactors, limit systems, and countless other parts
- When the operator emergency release lever is disengaged the door easily operates by hand
- Operates both 1" and 1-5/16" Dead Axle Rolling Sheet Doors
- Universal Left or Right hand mounting requiring only 1.5" of side clearance
- Simple wiring configurations and accessory modules that eliminate external limit relays to achieve various interlock configurations

Reliability

- Industrial components ensure years of service
- Long life phosphor bronze worm drive gear system
- DC Motor and controller eliminates the problem of stuck motor switches, limit system failures, burned out starting capacitors and A/C motor malfunctions



ZAP Controls
8815-SD Series II Super-Drive
 DC Commercial Dead Axle Rolling Sheet Door Operator

Technical information for the 8815-SD Series II

Controller dimensions:	6.5" H X 8.7" W X 4.7" D
Single phase voltage:	115V US, 208-230V US, 230V EU
Three phase voltage:	480V US (Special order) 8825(X)-3-480
Amp draw:	3.2A
Power rating:	1300 Newtons Equivalent to 1 HP
Control circuit voltage:	6VDC
Limits determination:	Physical/Self Calibrating
Duty cycle rating:	Continuous
Operating temp range:	-20 deg F to 212 deg F
Overload protection:	Inherent motor current sensing
Lubrication:	Permanent
Door axle type required:	Dead Axle
Fits Torsion shafts diameter:	1-5/16" Standard 1" w/adaptor PN 600249
Side clearance required:	1.5"
Replacement red motor PN	600816
Replacement belt PN/size	8815-SD 600621 (AX38)

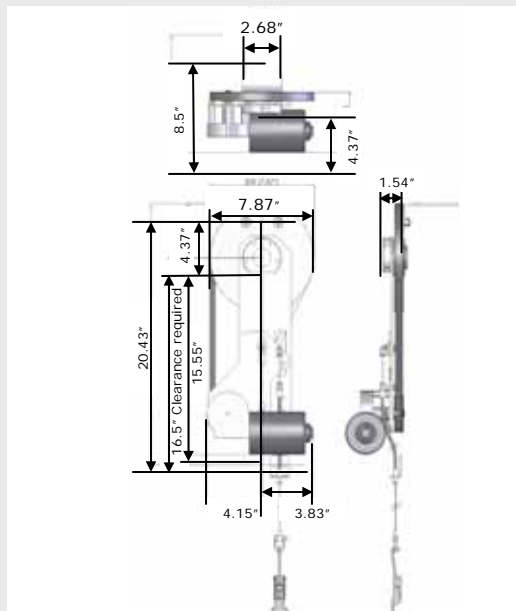

8815 II SD US

ZAP Series II

Not For Use In Residential Applications

Simply Logical

ZAP Controls
 100 Waterloo Blvd. Anglesey Business Park, Littleworth Road, Cannock, Staffordshire, England
 UK Office Number 011-44-154-387-9444 sales@zap-uk.com
 Online www.zap-uk.com

ZAP Controls

8815-SD Series II Super-Drive

Commercial DC Dead Axle Rolling Sheet Door Operator

Door Size W X H	
3'-18"W X 3'6" - 4'6"H	8815-II-SD With Short run Chip
3'-18"W X 8'6" - 10'H	8815-II-SD
3'-14"W X 8'6" - 14'H	8815-II-SD

Please read the instructions fully or attend training online before installation. Consult factory for door sizes beyond scope provided above.
Mount to 1-5/16" dead axle sheet door. 1" axle using adapter. PN 600249
The minimum door height is 8'6".
A short run chip is available for lower heights.

Standard Features

- **Motor and controller**
Continuous duty rated DC Motor with controller, producing a powerful soft start/soft stop output of 1300 Newtons of force to drive commercial rolling sheet doors while reducing mechanical impacts that cause premature wear of door components.
- **Drive reduction**
Worm drive gearbox & V-belt reduction drive with floor level, adjustable belt tensioning /emergency release lever.
- **Bearings and belts**
Drive systems use industrial grade bearings and automotive grade long life v-belts. Our simplistic service design concept allows simple service of components in a matter of moments.
- **Construction**
Heavy-duty 8-gauge electro-plate finish steel frame, industrial bearings, phosphor bronze worm drive gears, aluminum drive pulley, secured with key stock and setscrew for simple servicing.
- **Push button station**
Control unit acts as the standard 3-button station for open/close/stop functions. Controller may mounted remotely up to 24 feet away from the operator, provided it is to be wired with other external control devices that are designed to function as the primary door controls. Power supply is wired directly to the controller not the motor. Low voltage motor cable is supplied for easy wiring.

Value Added Standard Features

- **Automatic obstruction sensing system**
Inherent motor current sensing system monitors the entire door system for obstructions and unsafe operating conditions in both directions of travel. The system provides protections unavailable with traditional commercial operators and can automatically sense obstructions like locks, broken springs, unsafe service conditions, and other obstructions that cannot be detected by reversing edges and photo cells.
- **Safety stop and reverse**
Inherent motor current sensing system automatically incorporates and safety stop before reopening in soft start.
- **Auto-close timer**
Fully programmable auto-close timer automatically closes the door. (4 minutes) Requires the addition of approved photo cell.
- **Part open programming (Programmable mid stop)**
Programmable part open to stop door at predetermined height.
- **Prevent door operation interlock**
Built in interlock to prevent door operation, used with truck restraint systems, shared track applications or pass doors.
- **Max run time protection**
Inherent motor current sensing system provides automatic max runtime protection.
- **Service due reminder**
May be activated to ensure regularly scheduled maintenance based on cycles of usage.

- **Emergency egress manual operation**
Emergency manual operation using a ground level over-ride lever disconnect. When lever is released, the door will operate manually by hand as if no operator is connected to the door. This unique system eliminates the need to electrically interlock the disconnect as the operator has no mechanical limits and physically disconnects from all drive systems when released. It also provides ground level adjustment of the motor drive belt.
- **Versatile mounting configurations**
8815 3 SD may be mounted universally in the left hand or right hand position, requiring no specialty brackets for mounting.

Options and Accessories

- **Through Beam and Retro-reflective Photo Eyes**
401001 through beam commercial grade 4 wire photo eye
401000 retro-reflective commercial grade 4 wire photo eye
- **Receivers and transmitters**
2, 4, and 6 button handheld and permanently mounted forklift transmitters are available for use with the model 840 receiver. The 840 receiver module can use either an internal or optional external antenna.
- **Battery back up**
8830 Battery Back up systems allows operation of the operator during power outages.
- **Adapter insert**
600249 Adapter insert for converting operator to accept 25.4mm dead axle shafts.

Available Plug-in Modules

- **Auxiliary Input Expansion Module**
871 module allows for expansion of input functions and the application of external radio receivers from other manufacturers
- **Fire station module**
871 FS allows the incorporation of a second set of photo cells above man traffic height that will prevent the auto-close timer from timing out and closing a door before the vehicle has departed the facility. Once the vehicle has departed the opening fully, the timer is released.
- **Dock interlock/Traffic light control w/adv. warning**
82DTLM and the 822 Modules provide a N/O relay that closes when the door operator is in the fully opened position. It may be used as a dock interlock or to interlock a door that shares the same track system. Provides terminals to operate red/green driver communication lighting where mechanical dock levelers are used. 822 module provides advance warning of pending door closure with activation of the delay close programming. Terminals provided on 82DTLM may also be used to operate security, heating or other 5V to 240V devices up to 5 amps. Expansion port included for the addition of 8070 Auto-Lock, 871 FS, or 871 interface expansion modules.
- **Closed interlock/Traffic light control w/adv. warning**
82TLM and the 821 Modules provide a N/O relay that closes when the door operator is in the fully closed position. It may be used as a sally port interlock or to interlock any device that requires the door to be in the closed position. Provides terminals to operate red/green through traffic lights where it is desired to know the door is fully opened before proceeding through. 821 module provides advance warning of pending door closure with activation of the delay close programming. Terminals provided may also be used to operate security, heating or other 5V to 240V devices up to 5 amps. Expansion port is included for the addition of 8070 Auto-Lock, 871 FS, or 871 input expansion modules.
- **Loop detectors**
Both single, and twin loop detectors are available for either plug in or wall mount installation

ZAP Controls

825-SS Series II Super Drive

Safety

- Compact size reduces potential for lifting injuries during installation
- Universal shaft mounting system reduces the potential for unsafe work practices during installation
- Fully adjustable automatic obstruction sensing system detects obstructions on any part of the door in the open or close direction while monitoring the entire door movement for unsafe operation or service conditions
- Inherent soft start-soft stop, safety stop-reverse eliminates the mechanical stress damage to the door when the door reverses
- Self determining limit system prevents thrown cables from debris, ice, and snow left in the door opening

Value

- Continuous duty rated low voltage motor
- Ultra-Quiet DC Motor, will not thermally overload
- Built in Service Due reminder may be activated to ensure regular maintenance based on cycles of usage
- Fully programmable Timer-to-close
- Built in interlock terminals to prevent door operation
- Programmable mid-stop
- Motor maximum amperage draw 2.8 Amps reducing number circuits required for multiple door applications
- Automatic obstruction sensing system surpasses the capabilities of a sensing edge detecting obstructions on any part of the door, eliminating the cost of a safety edge and associated wiring
- Reduces the occurrence of catastrophic damage to the door

Simplicity

- Simple one person installation that eliminate steel build ups, front of hood mounts, welding, and specialty anchors
- Simplistic maintenance design concept
- PCB based system controller eliminates the cost of servicing electrical contactors, limit systems, and countless other parts
- When the operator emergency release lever is disengaged the door easily operates by hand
- Operates 1" Live Axle Rolling Sheet Doors
- Universal Left or Right hand mounting requiring 4.5" of side clearance
- Simple wiring configurations and accessory modules that eliminate external limit relays to achieve various interlock configurations

Reliability

- Industrial components ensure years of service
- DC Motor and controller eliminates the problem of stuck motor switches, limit system failures, burned out starting capacitors and A/C motor malfunctions



ZAP Controls
825-SS Series II Super-Drive
DC Commercial Live Axle Rolling Sheet Door Operator

Technical information for the 825 Series II

Controller dimensions:	6.5" H X 5.4" W X 4" D
Single phase voltage:	115V US, 208-230V US, 230V EU
Amp draw:	2.8A
Power rating:	650 Newtons Equivalent 1/2 HP
Control circuit voltage:	6VDC
Limits determination:	Physical/Self Calibrating
Duty cycle rating:	Continuous
Operating temp range:	-22 deg F to 212 deg F
Overload protection:	Inherent motor current sensing
Lubrication:	Permanent
Torsion shaft type required:	Solid w/keyway or hollow tube 1"
Fits torsion shafts diameter:	1"
Torsion shaft length required:	4.5" beyond outer track edge
Side clearance required:	4.5min for motor only
Replacement motor PN:	600805
Replacement belt PN/size:	825-D 600615 (AX25)

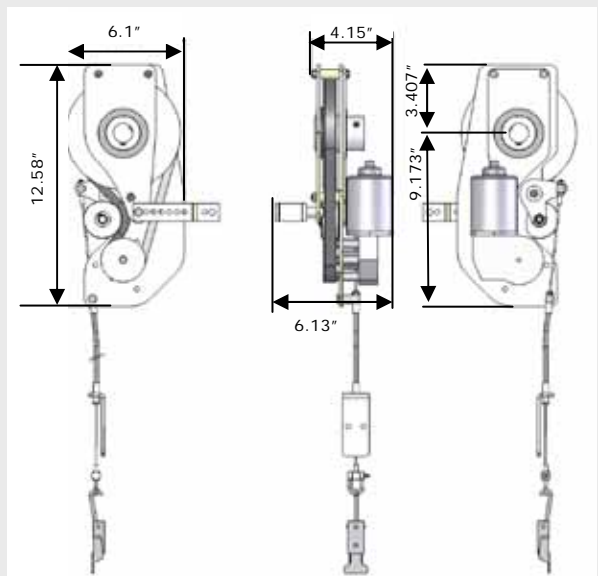

815 II SS US

ZAP Series II
Simply Logical

Not For Use In Residential Applications

ZAP Controls
100 Waterloo Blvd. Anglesey Business Park, Littleworth Road, Cannock, Staffordshire, England
UK Office Number 011-44-154-387-9444 sales@zap-uk.com
Online www.zap-uk.com

ZAP Controls

825-SS Series II Super-Drive

Commercial DC Live Axle Rolling Sheet Door Operator

Door Size W X H	
3'-12"W X 3'-5'-11"H	815-II-SS with Short run chip
3'-12"W X 6'-8"H	815-II-SS

Please read the instructions fully or attend training online before installation. Consult factory for door sizes beyond scope provided above. Mounts to 1" live axle sheet door. The minimum door height is 6'. Short run chip is available for lower heights.

Standard Features

- **Motor and controller**
Continuous duty rated DC Motor with controller, producing a powerful soft start/soft stop output of 650 Newtons of force to drive commercial rolling sheet doors while reducing mechanical impacts that cause premature wear of door components.
- **Drive reduction**
Worm drive gearbox & V-belt reduction drive with floor level, adjustable belt tensioning /emergency release lever.
- **Bearings and belts**
Drive systems use industrial grade bearings and automotive grade long life v-belts. Our simplistic service design concept allows simple service of components in a matter of moments.
- **Construction**
Heavy-duty 8-gauge electro-plate finish steel frame, industrial bearings, worm drive gear box, aluminum drive pulley, secured with key stock and setscrew for simple servicing.
- **Push button station**
Control unit acts as the standard 3-button station for open/close/stop functions. Controller may mounted remotely up to 24 feet away from the operator, provided it is to be wired with other external control devices that are designed to function as the primary door controls. Power supply is wired directly to the controller not the motor. Low voltage motor cable is supplied for easy wiring.

Value Added Standard Features

- **Automatic obstruction sensing system**
Inherent motor current sensing system monitors the entire door system for obstructions and unsafe operating conditions in both directions of travel. The system provides protections unavailable with traditional commercial operators and can automatically sense obstructions like locks, broken springs, unsafe service conditions, and other obstructions that cannot be detected by reversing edges and photo cells.
- **Safety stop and reverse**
Inherent motor current sensing system automatically incorporates and safety stop before reopening in soft start.
- **Auto-close timer**
Fully programmable auto-close timer automatically closes the door. (4 minutes) Requires the addition of approved photo cell.
- **Part open programming (Programmable mid stop)**
Programmable part open to stop door at predetermined height.
- **Prevent door operation interlock**
Built in interlock to prevent door operation, used with truck restraint systems, shared track applications or pass doors.
- **Max run time protection**
Inherent motor current sensing system provides automatic max runtime protection.
- **Service due reminder**
May be activated to ensure regularly scheduled maintenance based on cycles of usage.

- **Emergency egress manual operation**
Emergency manual operation using a ground level over-ride lever disconnect. When lever is released, the door will operate manually by hand as if no operator is connected to the door. This unique system eliminates the need to electrically interlock the disconnect as the operator has no mechanical limits and physically disconnects from all drive systems when released. It also provides ground level adjustment of the motor drive belt.

- **Versatile mounting configurations**
825 3 SS may be mounted universally in the left hand or right hand position, requiring no specialty brackets for mounting.

Options and Accessories

- **Through Beam and Retro-reflective Photo Eyes**
401001 through beam commercial grade 4 wire photo eye
401000 retro-reflective commercial grade 4 wire photo eye
- **Receivers and transmitters**
2, 4, and 6 button handheld and permanently mounted forklift transmitters are available for use with the model 840 receiver. The 840 receiver module can use either an internal or optional external antenna.
- **Battery back up**
8830 Battery Back up systems allows operation of the operator during power outages.

Available Plug-in Modules

- **Auxiliary Input Expansion Module**
871 module allows for expansion of input functions and the application of external radio receivers from other manufacturers
- **Fire station module**
871 FS allows the incorporation of a second set of photo cells above man traffic height that will prevent the auto-close timer from timing out and closing a door before the vehicle has departed the facility. Once the vehicle has departed the opening fully, the timer is released.
- **Dock interlock/Traffic light control w/adv. warning**
82DTLM and the 822 Modules provide a N/O relay that closes when the door operator is in the fully opened position. It may be used as a dock interlock or to interlock a door that shares the same track system. Provides terminals to operate red/green driver communication lighting where mechanical dock levelers are used. 822 module provides advance warning of pending door closure with activation of the delay close programming. Terminals provided on 82DTLM may also be used to operate security, heating or other 5V to 240V devices up to 5 amps. Expansion port included for the addition of 8070 Auto-Lock, 871 FS, or 871 interface expansion modules.
- **Closed interlock/Traffic light control w/adv. warning**
82TLM and the 821 Modules provide a N/O relay that closes when the door operator is in the fully closed position. It may be used as a sally port interlock or to interlock any device that requires the door to be in the closed position. Provides terminals to operate red/green through traffic lights where it is desired to know the door is fully opened before proceeding through. 821 module provides advance warning of pending door closure with activation of the delay close programming. Terminals provided may also be used to operate security, heating or other 5V to 240V devices up to 5 amps. Expansion port is included for the addition of 8070 Auto-Lock, 871 FS, or 871 input expansion modules.
- **Loop detectors**
Both single, and twin loop detectors are available for either plug in or wall mount installation

ZAP Controls

827 Series II Super Drive

Safety

- Compact size reduces potential for lifting injuries during installation
- Universal shaft mounting system reduces the potential for unsafe work practices during installation
- Fully adjustable automatic obstruction sensing system detects obstructions on any part of the door in the open or close direction while monitoring the entire door movement for unsafe operation or service conditions
- Inherent soft start-soft stop, safety stop-reverse eliminates the mechanical stress damage to the door when the door reverses
- Self determining limit system prevents thrown cables from debris, ice, and snow left in the door opening

Value

- Continuous duty rated low voltage motor
- Ultra-Quiet DC Motor, will not thermally overload
- Built in Service Due reminder may be activated to ensure regular maintenance based on cycles of usage
- Fully programmable Timer-to-close
- Built in interlock terminals to prevent door operation
- Programmable mid-stop
- Motor maximum amperage draw 2.8 Amps reducing number circuits required for multiple door applications
- Automatic obstruction sensing system surpasses the capabilities of a sensing edge detecting obstructions on any part of the door, eliminating the cost of a safety edge and associated wiring
- Reduces the occurrence of catastrophic damage to the door

Simplicity

- Simple one person installation that eliminate steel build ups, front of hood mounts, welding, and specialty anchors
- Simplistic maintenance design concept
- PCB based system controller eliminates the cost of servicing electrical contactors, limit systems, and countless other parts
- When the operator emergency release lever is disengaged the door easily operates by hand
- Operates 1" Dead Axle Mini Warehouse Rolling Sheet Doors
- Right hand mounting requiring 0" of side clearance
- Simple wiring configurations and accessory modules that eliminate external limit relays to achieve various interlock configurations

Reliability

- Industrial components ensure years of service
- DC Motor and controller eliminates the problem of stuck motor switches, limit system failures, burned out starting capacitors and A/C motor malfunctions



ZAP Controls
827 Series II Super-Drive
DC Commercial Compact Mini-Warehouse Sheet Door Operator

Technical information for the 827 Series II

Controller dimensions:	6.5" H X 5.4" W X 4" D
Single phase voltage:	115V US, 208-230V US, 230V EU
Amp draw:	2.8A
Power rating	650 Newtons Equivalent 1/2 HP
Control circuit voltage:	6VDC
Limits determination:	Physical/Self Calibrating
Duty cycle rating:	Continuous
Operating temp range:	-22 deg F to 212 deg F
Overload protection:	Inherent motor current sensing
Lubrication:	Permanent
Torsion shaft type required:	Solid w/keyway or hollow tube
Fits torsion shafts diameter:	1"
Torsion shaft length required:	4.5" beyond outer track edge
Side clearance required:	4.5min for motor only
Replacement motor PN	600805
Replacement belt PN/size	827 600626(Z17.5)

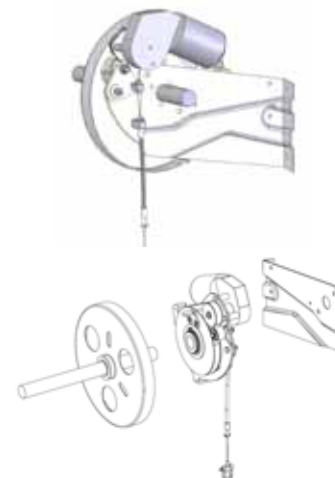

827 II US

ZAP Series II

Not For Use In Residential Applications

Simply Logical

ZAP Controls
100 Waterloo Blvd. Anglesey Business Park, Littleworth Road, Cannock, Staffordshire, England
UK Office Number 011-44-154-387-9444 sales@zap-uk.com
Online www.zap-uk.com

ZAP Controls

827 Series II Super-Drive

Commercial DC Live Axle Rolling Sheet Door Operator

Door Size W X H	
3'-9"W X 3'-5'11"H	827-II with Short run chip
3'-9"W X 6'-8"H	827-II

Please read the instructions fully or attend training online before installation. Consult factory for door sizes beyond scope provided above.

Mounts to 1" dead axle sheet door with mounting bracket depicted in drawing. The minimum door height is 6'. Short run chip is available for lower heights.

Standard Features

- **Motor and controller**
Continuous duty rated DC Motor with controller, producing a powerful soft start/soft stop output of 650 Newtons of force to drive commercial rolling sheet doors while reducing mechanical impacts that cause premature wear of door components.
- **NEMA 4X rated controller case**
- **Drive reduction**
Worm drive gearbox & V-belt reduction drive with floor level, adjustable belt tensioning /emergency release lever.
- **Bearings and belts**
Drive systems use industrial grade bearings and automotive grade long life v-belts. Our simplistic service design concept allows simple service of components in a matter of moments.
- **Construction**
Heavy-duty 8-gauge electro-plate finish steel frame, industrial bearings, worm drive gear box, aluminum drive pulley, secured with key stock and setscrew for simple servicing.
- **Push button station**
Control unit acts as the standard 3-button station for open/close/stop functions. Controller may mounted remotely up to 24 feet away from the operator, provided it is to be wired with other external control devices that are designed to function as the primary door controls. Power supply is wired directly to the controller not the motor. Low voltage motor cable is supplied for easy wiring.

Value Added Standard Features

- **Automatic obstruction sensing system**
Inherent motor current sensing system monitors the entire door system for obstructions and unsafe operating conditions in both directions of travel. The system provides protections unavailable with traditional commercial operators and can automatically sense obstructions like locks, broken springs, unsafe service conditions, and other obstructions that cannot be detected by reversing edges and photo cells.
- **Safety stop and reverse**
Inherent motor current sensing system automatically incorporates and Safety stop before reopening in soft start.
- **Auto-close timer**
Fully programmable auto-close timer automatically closes the door. (4 minutes) Requires the addition of approved photo cell.
- **Part open programming (Programmable mid stop)**
Programmable part open to stop door at predetermined height.
- **Prevent door operation interlock**
Built in interlock to prevent door operation, used with truck restraint systems, shared track applications or pass doors.
- **Max run time protection**
Inherent motor current sensing system provides automatic max runtime protection.
- **Service due reminder**
May be activated to ensure regularly scheduled maintenance based on cycles of usage.

- **Emergency egress manual operation**
Emergency manual operation using a ground level over-ride lever disconnect. When lever is released, the door will operate manually by hand as if no operator is connected to the door. This unique system eliminates the need to electrically interlock the disconnect as the operator has no mechanical limits and physically disconnects from all drive systems when released. It also provides ground level adjustment of the motor drive belt.

Options and Accessories

- **Through Beam and Retro-reflective Photo Eyes**
401001 through beam commercial grade 4 wire photo eye
401000 retro-reflective commercial grade 4 wire photo eye
- **Receivers and transmitters**
2, 4, and 6 button handheld and permanently mounted forklift transmitters are available for use with the model 840 receiver. The 840 receiver module can use either an internal or optional external antenna. Terminals are provided inside the controller to facilitate the use of a 24VDC external receiver from any radio control manufacturer.
- **Battery back up**
8830 Battery Back up systems allows operation of the operator during power outages.

Available Plug-in Modules

- **Auxiliary Input Expansion Module**
871 module allows for expansion of input functions and the application of external radio receivers from other manufacturers
- **Dock interlock/Traffic light control w/adv. warning**
82DTLM and the 822 Modules provide a N/O relay that closes when the door operator is in the fully opened position. It may be used as a dock interlock or to interlock a door that shares the same track system. Provides terminals to operate red/green driver communication lighting where mechanical dock levelers are used. 822 module provides advance warning of pending door closure with activation of the delay close programming. Terminals provided on 82DTLM may also be used to operate security, heating or other 5V to 240V devices up to 5 amps. Expansion port included for the addition of 8070 Auto-Lock, 871 FS, or 871 interface expansion modules.
- **Closed interlock/Traffic light control w/adv. warning**
82TLM and the 821 Modules provide a N/O relay that closes when the door operator is in the fully closed position. It may be used as a sally port interlock or to interlock any device that requires the door to be in the closed position. Provides terminals to operate red/green through traffic lights where it is desired to know the door is fully opened before proceeding through. 821 module provides advance warning of pending door closure with activation of the delay close programming. Terminals provided may also be used to operate security, heating or other 5V to 240V devices up to 5 amps. Expansion port is included for the addition of 8070 Auto-Lock, 871 FS, or 871 input expansion modules.
- **Loop detectors**
Both single, and twin loop detectors are available for either plug in or wall mount installation

ZAP Controls

Accessory Specifications

ZAP Controls

Accessory Specifications

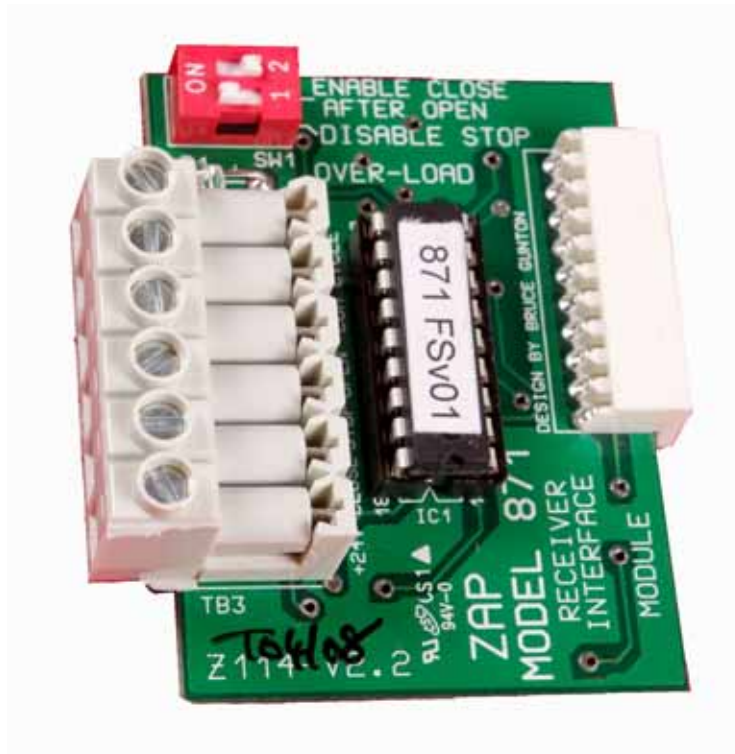

ZAP Series II Simply Logical

ZAP Controls
100 Waterloo Blvd. Anglesey Business Park, Littleworth Road, Cannock, Staffordshire, England
UK Office Number 011-44-154-387-9444 sales@zap-uk.com
Online www.zap-uk.com

ZAP Controls

871 Interface Expansion Module

ZAP Part# 871

Description:

The 871 Interface Expansion Module is a plug-in module that allows additional expansion room for the input of external control devices such as three channel external radio control receiver for open stop and close function via radio transmitter, microwave sensors, and loop detectors.

Operations provided:

N/O Single contact operation (Cyclic)
N/O Single contact operation (Open)
N/O Single contact operation (Close)
N/O Single contact operation (Stop)

Input terminals provided:

Open/Stop/Close/Common/Cycle

Output terminal provided:

24VDC power

Overload protection circuit:

LED illuminates if the power supply is over-loaded, due to a fault or by a device drawing too much current.

Wiring requirements:

14-20 AWG

Power requirement:

None

Mounting type:

Plug in

Terminal plug:

6 Position Dual Direction slide in plug

Dimensions:

Height: 1 7/8"
Width: 2 1/8"
Depth: 3/4"

Operating temp:

-13 deg F to + 149 deg F

Works with:

All Commercial ZAP Controllers
82-TLM
82DTLM
8070 Auto-Lock (requires 872 Adapter)



ZAP Controls

871-FS Fire Station Module

ZAP Part# 871-FS

Description:

The 871 Fire Station Module is a special variant of the 871 Interface Expansion Module. It allows the use of a second photo-cell system to inhibit the Auto-Close function of standard ZAP Operator until an emergency vehicle departing a facility has passed through the photo cell beam and exited the facility fully. This prevents the circumstance that causes damage to many fire station and ambulance station sectional doors by fault of the timer to close timer closing the door before the vehicle has left the facility. Once the departing emergency vehicle has passed through the photo cells' beam, the Auto-Close timer is then released and allowed to time out and the door closes.

Operations provided:

Hold Open signal when using Auto Close Timer is employed until vehicle departs facility.

Input terminals provided:

Open/Stop/Close/Common/Cycle

Output terminal provided:

24VDC power

Overload protection circuit:

LED illuminates if the power supply is over-loaded, due to a fault or by a device drawing too much current.

Wiring requirements:

14-20 AWG

Wiring required:

N/C Photo eye safety connection (Cyclic)
N/C Photo eye common connection (Com)

Power requirement:

None

Mounting type:

Plug in

Terminal plug:

6 Position Dual Direction slide in plug

Dimensions:

Height: 1 7/8"
Width: 2 1/8"
Depth: 3/4"



Operating Temp:

-13 deg F to + 149 deg F

Works with:

All ZAP Controllers except 8850 Turbo
82-TLM
82DTLM
8070 Auto-Lock (requires 872 Adapter)

As close function on controller case lid is not functional when 871 FS is employed it is necessary to disconnect Close wire (grey) from TB3 on ZAP control board and wire to close terminal on 871 FS .

ZAP Controls
871-FS Fire Station Module

871 FS US

ZAP Series II

Simply Logical

ZAP Controls
100 Waterloo Blvd. Anglesey Business Park, Littleworth Road, Cannock, Staffordshire, England
UK Office Number 011-44-154-387-9444 sales@zap-uk.com
Online www.zap-uk.com

ZAP Controls

872 Adapter Module

ZAP Part# 872

Description:

The 872 Adapter Module is a plug-in adapter that provides dual 10 way pin connections for the dual use of certain ZAP accessories.

Wiring requirement:

None

Power requirement:

None

Mounting type:

Plug in

Terminal plug:

Dual 10 Pin Socket Headers

Dimensions:

Height: 2 5/16"

Width: 2"

Depth: 9/16"

Operating temp:

-13 deg F to + 149 deg F

Works with:

All ZAP Controllers

8070 Auto-Lock

871 Interface Module

871-FS (Not with Turbo Drive)

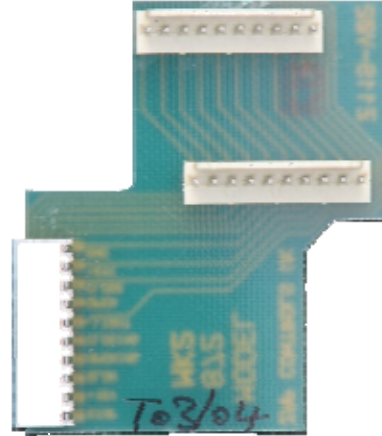

ZAP Controls

8070 Auto-Lock

ZAP Part# 8070

Description:

8070 Auto-Lock provides integrated security with an electronic solenoid locking system that releases a shoot bolt above a roller when door is stopped and withdraws prior to door operation.

Wiring requirements:

Provided

Power requirement:

None

Mounting type:

8067 Module: Plug in

8068 Solenoid bolt assembly: Bolt on

Terminal plug:

2 Position Dual Direction slide in plug

2 Male, Female shielded terminals

Works with:

All Commercial ZAP Controllers

82-TLM

82DTLM

871 Interface module (requires 872 Adapter)

871-FS (requires 872 Adapter)

8067 module dimensions:

Height: 4 3/4"

Depth: 4"

Width: 1 3/4"

Solenoid bolt frame dimensions:

Height: 4 1/4"

Depth: 3 1/4"

Width: 1 1/8"

Cover dimensions:

Height: 4 9/16"

Depth: 3 1/2"

Width: 2 1/2"

Operating temp:

-13 deg F to + 149 deg F

Replacement parts:

PN-8067 Plug-in module,

PN-8068 Solenoid bolt assembly

PN-ZA0074 Power cable

PN-601431 Solenoid cover



ZAP Controls
8070 Auto-Lock

8070 US

ZAP Series II

Simply Logical

ZAP Controls
100 Waterloo Blvd. Anglesey Business Park, Littleworth Road, Cannock, Staffordshire, England
UK Office Number 011-44-154-387-9444 sales@zap-uk.com
Online www.zap-uk.com

ZAP Controls

8830 Battery Back up

ZAP Part# 8830

Description:

The 8830 Commercial Operator Battery Back Up system is designed for use with all standard ZAP Commercial operators. Zap Controllers provide a constant charge to the battery system and automatically engage them in the event a power interruption and automatically disengage and resume charging upon restoration of the power supply.

Wiring requirements:

18 AWG/6

Power requirement:

16VDC Provided from controller

Mounting type:

Wall mount

Terminal plug:

6 Position Dual Direction slide in plug

Voltage output:

12VDC, 24VDC, 48VDC

Battery type:

Sealed Lead Acid

Charging system:

Current Limited Constant Voltage
Short Circuit and Reverse Connection Proof

Run time average:

10 Cycles

Dimensions:

Height: 8.5"
Width: 6.5"
Depth: 4.25"

Operating temp:

-13 deg F to + 149 deg F

Works with:

All standard commercial ZAP Controllers



ZAP Controls
8830 Battery Back up

8830 US

ZAP Series II Simply Logical

ZAP Controls
100 Waterloo Blvd. Anglesey Business Park, Littleworth Road, Cannock, Staffordshire, England
UK Office Number 011-44-154-387-9444 sales@zap-uk.com
Online www.zap-uk.com

ZAP Controls

82 DTLM Dock Interlock/Dock Traffic Light Control

ZAP Part# 82 DTLM

Description:

82 DTLM provides a N/O relay that closes when the door operator is in the fully opened position. It may be used as a dock interlock or to interlock a door that shares the same track system. Provides terminals to operate red/green driver communication lighting where mechanical dock levelers are used. Terminals provided may be used to operate security, heating or other 5V to 240V devices up to 5 amps. Interlocking 120V/240V device control circuits higher than 5 amps requires the addition of the ZA0192 Slave Relay Kit. Expansion port included for the addition of 8070 Auto-Lock, 871 FS, or 871 input modules.

Interlock terminals:

Interlock N/O relay closes when door is in fully open position.

Driver communication light terminals:

Red Light-N/O Relay closes when door is in any position other than fully closed position.
Green Light-N/O Relay closes when door is in fully closed position.

Common
24V

Wiring requirements:

14-20 AWG

Power requirement:

None

Mounting type:

Plug in

Terminal plug:

2 Position Dual Direction slide in plug
4 Position Dual Direction slide in plug

Works with:

All Commercial ZAP Controllers
871 Interface expansion module
871-FS

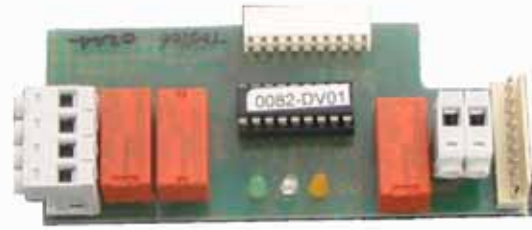

Dimensions:

Height: 1-5/8"
Width: 3 -5/8"
Depth: 7/8"

Operating temp:

-13 deg F to + 149 deg F
F

ZAP Controls
82 DTLM Dock Interlock/Dock Traffic Light Control

82DTLM US

ZAP Series II
Simply Logical

ZAP Controls
100 Waterloo Blvd. Anglesey Business Park, Littleworth Road, Cannock, Staffordshire, England
UK Office Number 011-44-154-387-9444 sales@zap-uk.com
Online www.zap-uk.com

ZAP Controls

ZA0192 Slave Relay Adapter Kit for 82DTLM

ZAP Part# ZA0192

Description:

ZA0192 Slave relay module is designed for use in conjunction with the 82DTLM where the 82DTLM is to be interfaced as an interlock into an existing control circuit of 120-240V with an amperage draw of more than the 5A allowed on the 82DTLM.

Wiring requirements:

14-20 AWG prewired to terminals for simple plug in application.

Power requirement:

24VDC

Mounting type:

Plug in

Terminal plug:

2 Position Dual Direction slide in plug
3 Position Dual Direction slide in plug

Works with:

All Commercial ZAP Controllers using the 82DTLM.

Operating temp:

-13 deg F to + 149 deg F



ZAP Controls
ZA0192 Slave Relay Adapter Kit for 82DTLM

ZA0192 US

ZAP Series II Simply Logical

ZAP Controls
100 Waterloo Blvd. Anglesey Business Park, Littleworth Road, Cannock, Staffordshire, England
UK Office Number 011-44-154-387-9444 sales@zap-uk.com
Online www.zap-uk.com

ZAP Controls

822 Dock Interlock/Advance door closure warning

ZAP Part# 822

Description:

822 provides a N/O relay that closes when the door operator is in the fully opened position. It may be used as a dock interlock or to interlock a door that shares the same track system. Provides terminals to operate red/green driver communication lighting where mechanical dock levelers are used. If programmed with built in close delay timer, module will facilitate the pre-announcement of pending door closure through the traffic light or an audible warning device. Expansion port included for the addition of 8070 Auto-Lock, 871 FS, or 871 input modules.

Interlock terminals:

Interlock N/O relay closes when door is in fully open position.

Driver communication light terminals:

Red Light-N/O Relay closes when door is in any position other than fully closed position.
Green Light-N/O Relay closes when door is in fully closed position.
Common
24V

Wiring requirements:

14-20 AWG

Power requirement:

None

Mounting type:

Plug in

Terminal plug:

2 Position Dual Direction slide in plug
4 Position Dual Direction slide in plug

Works with:

All Commercial ZAP Controllers
871 Interface expansion module
871-FS

Dimensions:

Height: 1-5/8"
Width: 3 -5/8"
Depth: 7/8"



Operating temp:

-13 deg F to + 149 deg F

DIP switch functions:

If the FLASH dip switch is set to ON then the RED output will flash on and off while the door is moving, if the door is stopped before it is fully opened or closed and during the delay before closing.

If the FLASH dip switch is set to OFF then the RED output will remain on constantly in these situations.

If the FUNCTION dip switch is set to ON then the RED output will be off after the power is first applied or if the door is fully opened.

If the FUNCTION dip switch is OFF then the RED output will remain on constantly in these situations.

ZAP Controls

82 TLM Through traffic light module/Door closed interlock

ZAP Part# 82 TLM

Description:

82TLM provides a N/O relay that closes when the door operator is in the fully closed position. It may be used as a sally port interlock or to inter lock any device that requires the door to be in the closed position. Provides terminals to operate red/green through traffic lights where it is desired to know the door is fully opened before proceeding through. Terminals provided may also be used to operate security, heating or other 5V to 240V devices up to 5 amps. Expansion port is included for the addition of 8070 Auto-Lock, 871 FS, or 871 input expansion modules.

Trough traffic light terminals:

Red Light-N/O Relay closes when door is in any position other than fully open.
Green Light-N/O Relay closes when door is in fully open position.
Common
24V

Interlock terminals:

Interlock N/O relay closes when door is in fully closed position.

Wiring requirements:

14-20 AWG

Power requirement:

None

Mounting type:

Plug in

Terminal pug:

2 Position Dual Direction slide in plug
4 Position Dual Direction slide in plug

Dimensions:

Height: 1-5/8"
Width: 3 -5/8"
Depth: 7/8"

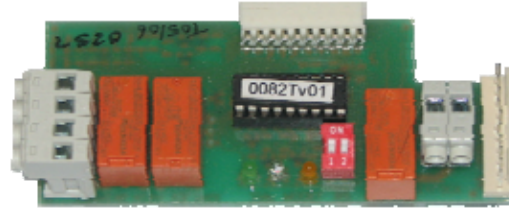

Operating temp:

-13 deg F to + 149 deg F

Works with:

All Commercial ZAP Controllers
871 Interface module
871-FS

Settings 2 Way DIP Switch:

Switch 1-When "on" the red traffic light will switch off 3 minutes after the door has closed
Switch 2-When "on" the red traffic light will flash while the door is moving.

ZAP Controls

821 Through traffic light module/Advance door closure warning

ZAP Part# 821

Description:

821 provides a N/O relay that closes when the door operator is in the fully closed position. It may be used as a sally port interlock or to inter lock any device that requires the door to be in the closed position. Provides terminals to operate red/green through traffic lights where it is desired to know the door is fully opened before proceeding through. If programmed with built in close delay timer, module will facilitate the pre-announcement of pending door closure through the traffic light or an audible warning device. Expansion port is included for the addition of 8070 Auto-Lock, 871 FS, or 871 input expansion modules.

Trough traffic light terminals:

Red Light-N/O Relay closes when door is in any position other than fully open.
Green Light-N/O Relay closes when door is in fully open position.
Common
24V

Interlock terminals:

Interlock N/O relay closes when door is in fully closed position.

Wiring requirements:

14-20 AWG

Power requirement:

None

Mounting type:

Plug in

Terminal plug:

2 Position Dual Direction slide in plug
4 Position Dual Direction slide in plug

Dimensions:

Height: 1-5/8"
Width: 3 -5/8"
Depth: 7/8"

Operating temp:

-13 deg F to + 149 deg F



Works with:

All Commercial ZAP Controllers
871 Interface module
871-FS

DIP switch functions

If the FLASH dip switch is set to ON then the RED output will flash on and off while the door is moving, if the door is stopped before it is fully opened or closed and during the delay before closing.

If the FLASH dip switch is set to OFF then the RED output will remain on constantly in these situations.

If the FUNCTION dip switch is set to ON then the RED output will turn off three minutes after the power is first applied or the door has fully closed.

If the FUNCTION dip switch is OFF then the RED output will remain on constantly in these situations.

ZAP Controls
821 Through traffic light module/Advance door closure warning

821 US

ZAP Series II

Simply Logical

ZAP Controls
100 Waterloo Blvd. Anglesey Business Park, Littleworth Road, Cannock, Staffordshire, England
UK Office Number 011-44-154-387-9444 sales@zap-uk.com
Online www.zap-uk.com

ZAP Controls

850 Audible Beeper Module

ZAP Part# 850

Description:

The 850 Beeper Module enables audible announcement of programming functions, cycle activation, Service Due Reminder, cycle count inquiries, and Auto-Close defeat. The 8830 Commercial Operator Battery Back Up system is designed for use with all standard ZAP Commercial operators.

Mounting type:

Plug in

Wiring requirements:

None

Power requirement:

None

Dimensions:

Height: 1-5/8"

Width: 7/8"

Depth: 3/4"

Operating temp:

-13 deg F to + 149 deg F

Works with:

All standard commercial ZAP Controllers



ZAP Controls
850 Audible Beeper Module

850 US

ZAP Series II Simply Logical

ZAP Controls
100 Waterloo Blvd. Anglesey Business Park, Littleworth Road, Cannock, Staffordshire, England
UK Office Number 011-44-154-387-9444 sales@zap-uk.com
Online www.zap-uk.com

ZAP Controls

401001 Through Beam photo cell

ZAP Part# 401001

Description:

Provides a polarized infrared light through separate sending and receiving photo cells to sense traffic and or obstructions in the door opening. The unit has a 20 meter through beam operating range, universal polarity supply, and robust compact plastic housing. Visible red beams aids alignment. Adjustable sensitivity with position indicator. Isolated changeover relay contacts.

Wiring requirement:

14-20 AWG

Power requirement:

12-24VDC
120VAC-240VAC

Mounting type:

Wall Mount

Dimensions:

Height: 1-5/8"
Width: 7/8"
Depth: 3/4"

Operating temp:

-13 deg F to + 149 deg F

Works with:

871-FS
8855 Turbo drive Fire Station model to facilitate Auto-close Fire Station programming

Not For UL 325 2010 Use



ZAP Controls
401001 Through Beam photo cell

401001 US

ZAP Series II Simply Logical

ZAP Controls
100 Waterloo Blvd. Anglesey Business Park, Littleworth Road, Cannock, Staffordshire, England
UK Office Number 011-44-154-387-9444 sales@zap-uk.com
Online www.zap-uk.com

ZAP Controls

401000 Retro-reflective photo cell

ZAP Part# 401000

Description:

Provides a polarized infrared light through a sending/receiver photo cell to a reflector to sense traffic and or obstructions in the door opening. The unit has a 10 meter Retro-reflective operating range, universal polarity supply, and robust compact plastic housing. Visible red beams aids alignment. Adjustable sensitivity with position indicator. Isolated changeover relay contacts.

Wiring requirement:

14-20 AWG

Power requirement:

12-24VDC
120VAC-240VAC

Mounting type:

Wall Mount

Dimensions:

Height:	1-5/8"	42mm
Width:	7/8"	22mm
Depth:	3/4"	19mm

Operating Temp:

-13 deg F to + 149 deg F
-25 deg C to +65 deg C

Works with:

All Series II Controllers
871-FS
8855 Turbo drive Fire Station model to facilitate Auto-close Fire Station programming



ZAP Controls
401000 Retro-reflective photo cell

401000 US

ZAP Series II Simply Logical

ZAP Controls
100 Waterloo Blvd. Anglesey Business Park, Littleworth Road, Cannock, Staffordshire, England
UK Office Number 011-44-154-387-9444 sales@zap-uk.com
Online www.zap-uk.com

ZAP Controls

840 Plug In Receiver/2416 Internal Antenna/2414 External Antenna

ZAP Controls
840 Plug In Receiver/2416 Internal Antenna/2414 External Antenna

ZAP Part# 840

Description:

Zap plug-in radio receiver with signal light.

Wiring requirements:

None

Power requirement:

None

Mounting type:

Plug in

Programming:

Program button on main control panel.

Operating temp:

-13 deg F to + 149 deg F

Works with:

871-FS

8855 Turbo drive Fire Station model to facilitate Auto-close Fire Station programming

Operating frequency:

433.92 Mhz.

Number of transmitters accepted:

Up to 60 Zap Transmitters on commercial models
825 3.0/8825 3.0. Up to 10 ZAP transmitters on other models.

Antennas

Internal: Model 2416

Plug-in internal antenna for standard use. The 2416 is not recommended for use where there is a steel building or a lack of windows.

Mounting type:

Plug in

Terminal plug:

2 Position Dual Direction slide in plug

Operating temp:

-13 deg F to + 149 deg F

840



2416



2414



External: Model 2414

Wall mounting case with external adjustable direction antenna for use where signal shielding caused by a steel building or any other facility where a lack of windows is prevalent.

Wiring requirement:

Coaxial provided

Terminal plug:

2 Position Dual Direction slide in plug

Mounting type:

Wall mount

Cable length:

10'

Dimensions:

Height: 4 1/2"
Width: 2 7/8"
Depth: 2 3/8"

Operating temp:

-13 deg F to + 149 deg F

840 2416 2414 US

ZAP Series II

Simply Logical

ZAP Controls
100 Waterloo Blvd. Anglesey Business Park, Littleworth Road, Cannock, Staffordshire, England
UK Office Number 011-44-154-387-9444 sales@zap-uk.com
Online www.zap-uk.com

ZAP Controls

4305-A, 4202, 4113 Handheld Radio Control Transmitters



4305-A

Channels: 6

Dimensions:

Length: 5-7/16"
Width: 2-1/4"
Depth: 13/16"

Description:

6 channel hand held transmitter. The transmitter features an extra heavy duty plastic housing with a rubber grip around the sides of the transmitter to take the abuse associated with forklift use. High visibility orange plastic housing.

Battery: 9 Volt Type: PP3

Operating temperature: -13 deg F to + 149 deg F

Operating frequency: 433.92 MHz



4202

Channels: 2

Dimensions:

Length: 5-9/16"
Width: 1-9/16"
Depth: 7/16"
With Visor Clip: 1-5/8"

Description:

2 channel transmitter with visor clip. The transmitter also features a series of led indicators that flash back and forth after releasing the transmit button to signal activation. Silver plastic housing.

Battery:

Button type: CR1632
Qty required: 4 ea
ZAP Part#: 400409
Pkg of 25 ea

Operating temperature: -13 deg F to + 149 deg F

Operating frequency: 433.92 MHz



4113

Channels: 4

Dimensions:

Length: 3"
Width: 1-1/4"
Depth: 1/2"

Description:

4 channel key-fob transmitter. The transmitter features an led indicator to signal activation. Magenta plastic housing.

Battery: Button type: CR292

Qty required: 4 ea
ZAP Part#: 400402
Pkg of 20 ea

Operating temp: -13 deg F to + 149 deg F

Operating frequency: 433.92 Mhz.

ZAP Controls
4305-A, 4202, 4113 Handheld Radio Control Transmitters

4305A 4202 4113 US

ZAP Series II Simply Logical

ZAP Controls
100 Waterloo Blvd. Anglesey Business Park, Littleworth Road, Cannock, Staffordshire, England
UK Office Number 011-44-154-387-9444 sales@zap-uk.com
Online www.zap-uk.com

ZAP Controls

Forklift Radio Control Transmitters

4500-50

Description:

Forklift mounted transmitter. The transmitter features a heavy duty die-cast aluminum housing in a high visibility orange color and are rated for indoor use. The transmitter is designed to permanently mount to the forklift, eliminating the constant loss associated with handheld transmitters. The units permanently wire to the forklift battery system and offer a voltage range of 12 to 72 volts dc. Models are available in 1, 2, 4, and 6 channels.

ZAP part numbers:	4501-50	1 button
	4502-50	2 button
	4504-50	4 button
	4506-50	6 button

Case dimensions:

Length:	4-1/2"
w/ antenna:	6-3/4"
Width:	2-1/2"
Depth:	2-3/16"

Works with: 840 Receiver

Battery: None

Frequency: 433.92 Mhz.

Operating temperature:

-13 deg F to + 149 deg F



4500-66

Description:

Forklift mounted transmitter. The transmitter features a heavy duty die-cast aluminum housing in a high visibility orange color and are rated for outdoor use. The transmitter is designed to permanently mount to the forklift, eliminating the constant loss associated with handheld transmitters. The units permanently wire to the forklift battery system and offer a voltage range of 12 to 72 volts dc. Models are available in 1, 2, 4, and 6 channels.

ZAP part numbers:	4501-66	1 button
	4502-66	2 button
	4504-66	4 button
	4506-66	6 button

Case Dimensions:

Length:	4-1/2"
w/ antenna:	6-3/4"
Width:	2-1/2"
Depth:	2-3/16"

Works with: 840 Receiver

Battery: None

Frequency: 433.92 Mhz.

Operating temperature:

-13 deg F to + 149 deg F



4500-50 4500-66 US

**ZAP Series II
Simply Logical**

ZAP Controls
100 Waterloo Blvd. Anglesey Business Park, Littleworth Road, Cannock, Staffordshire, England
UK Office Number 011-44-154-387-9444 sales@zap-uk.com
Online www.zap-uk.com

ZAP Controls

Loop Detectors 1102/1100-CC/1104-CC-120/240

1102

Description:

The 1102 is a plug in single magnetic loop detector used for indicating the presence or passage of vehicles. A system consists of an inductive loop (not provided) and the 1102 Loop detector.



1102

Wiring requirements: 14-20 AWG

Power requirement: None

Mounting type: Plug in

Dimensions: 1102

Height: 3.5"

Width: 3.5"

Depth: 1"

Works with:

All commercial ZAP Controllers

Operating temperature:

-13 deg F to + 149 deg F

1100-CC

The 1100-CC is a wall mount single magnetic loop detector used for indicating the presence or passage of vehicles. A system consists of an inductive loop (not provided) and the 1100 Loop detector.



1100-CC/1104-CC-120/240

Wiring requirements: 14-20 AWG

Power requirement:

1100-CC 24VDC

1104-CC-120 120VAC

1104-CC-240 240VAC

Case dimensions:

Height: 6.693"

Width: 5.512"

Depth: 5.315"

Mounting type:

Wall mount, Loop detector mounts on din rail.

Works with:

All commercial ZAP Controllers

1104-CC-120

1104-CC-240

The 1104-CC is a wall mount twin magnetic loop detector used for indicating the presence or passage of vehicles. A system consists of an inductive loop (not provided) and the 1104 loop detector.



Operating temperature:

-13 deg F to + 149 deg F

1100 1102 1104 US

ZAP Series II

Simply Logical

ZAP Controls
100 Waterloo Blvd. Anglesey Business Park, Littleworth Road, Cannock, Staffordshire, England
UK Office Number 011-44-154-387-9444 sales@zap-uk.com
Online www.zap-uk.com

ZAP Controls
Loop Detectors 1102/1100-CC/1104-CC-120/240

ZAP Controls

Parts Catalog

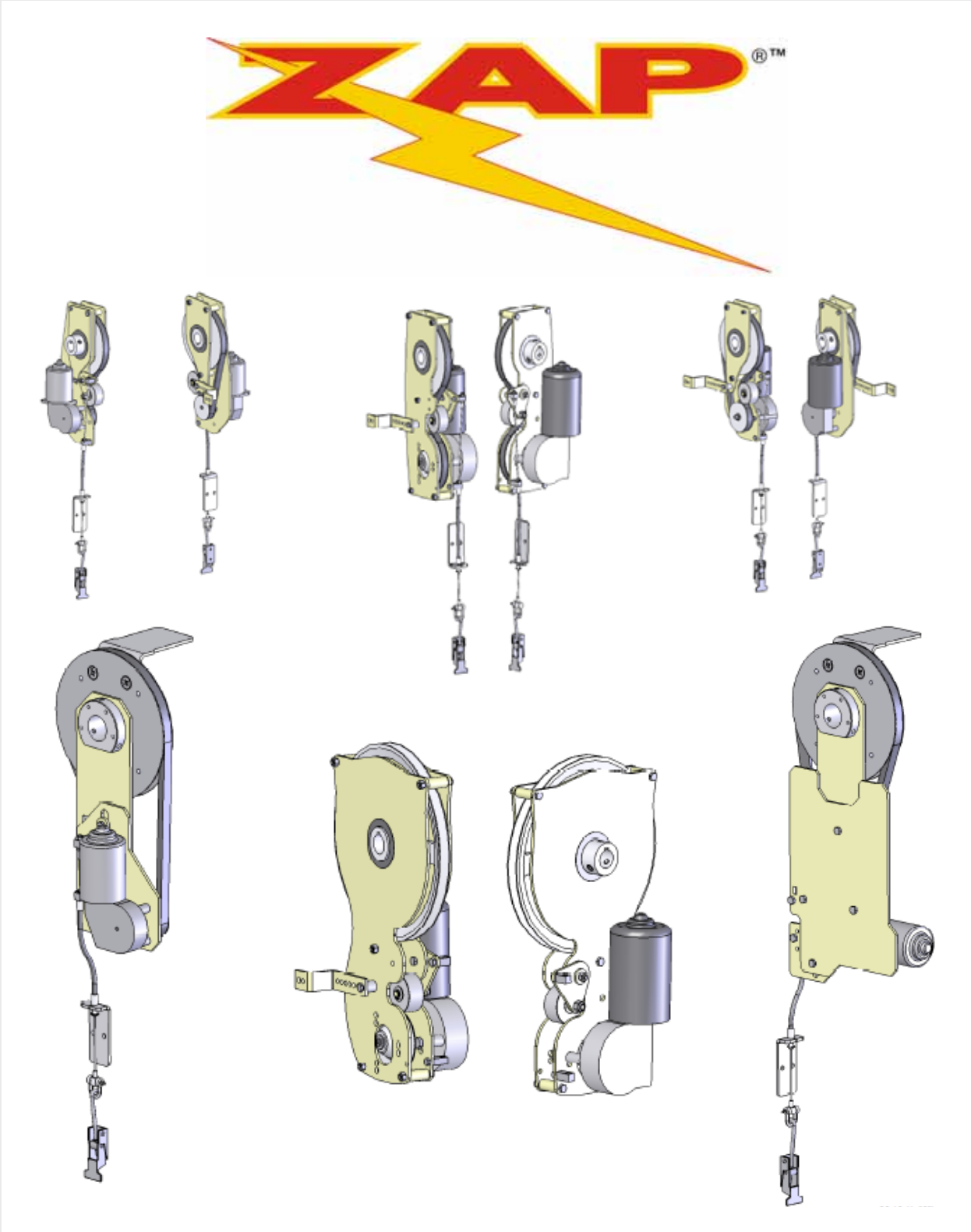

PARTS US

ZAP Series II Simply Logical

ZAP Controls
100 Waterloo Blvd. Anglesey Business Park, Littleworth Road, Cannock, Staffordshire, England
UK Office Number 011-44-154-387-9444 sales@zap-uk.com
Online www.zap-uk.com

ZAP Controls

ZAP Motor, Pulley, Belt Replacement/Configuration

ZAP Controls
ZAP Motor, Pulley, Belt Replacement/Configuration

Model	Replacement Motor	Replacement Belt	Motor Pulley	Driven Pulley
805B	600805	600600(Ax20)	600220(50MM)	ZA0048(4")
805C	600805	600601(Ax21)	600219(46MM)	ZA0049(5")
805D	600805	600602(Ax23)	600219(46MM)	ZA0050(6")
8805B	600810* See special notation	600618(Ax22.5)	600222(70MM)	ZA0048(4")
8805C	600810* See special notation	600606(Ax24)	600222(70MM)	ZA0049(5")
8805D	600810* See special notation	600611(Ax26)	600222(70MM)	ZA0050(6")
815RLB	600805	600601(Ax21)	600220(50MM)	600230(4")
815RLC	600805	600600(Ax20)	600219(46MM)	600230(4")
815RGB	600805	600601(Ax21)	600220(50MM)	ZA0048(4")
815RGC	600805	600600(Ax20)	600219(46MM)	ZA0048(4")
815B	600805	600600(Ax20)	600220(50MM)	ZA0048(4")
815C	600805	600601(Ax21)	600219(46MM)	ZA0049(5")
815D	600805	600602(Ax23)	600219(46MM)	ZA0050(6")
816B	600805	600601(Ax21)	600220(50MM)	ZA0084(4")
816C	600805	600602(Ax23)	600219(46MM)	ZA0085(5")
816D	600805	600615(Ax25)	600219(46MM)	ZA0086(6")
8815B	600810* See special notation	600618(Ax22.5)	600222(70MM)	ZA0048(4")
8815C	600810* See special notation	600606(Ax24)	600222(70MM)	ZA0049(5")
8815D	600810* See special notation	600611(Ax26)	600222(70MM)	ZA0050(6")
8816B	600810* See special notation	600615(Ax25)	600222(70MM)	ZA0084(4")
8816C	600810* See special notation	600614(Ax27)	600222(70MM)	ZA0085(5")
8816D	600810* See special notation	600617(Ax29)	600222(70MM)	ZA0086(6")
825B	600805	600612(Ax22)	600220(50MM)	ZA0048(4")
825C	600805	600602(Ax23)	600219(46MM)	ZA0049(5")
825D	600805	600615(Ax25)	600219(46MM)	ZA0050(6")
8825B	600810* See special notation	600602(Ax23)	600222(70MM)	ZA0048(4")
8825C	600810* See special notation	600615(Ax25)	600222(70MM)	ZA0049(5")
8825D	600810* See special notation	600614(Ax27)	600222(70MM)	ZA0050(6")
Special Notations				
*Part no longer available- Replace motor head assembly with 8825-3.0-HW(X) (B/C/D)				
**Part no longer available- Replace motor head assembly with 8826-3.0-HW(X) (B/C/D)				

Model	Replacement Motor	Replacement Belt	Motor Pulley	Driven Pulley
8826B	600810** See special notation	600624(Ax25.5)	600222(70MM)	ZA0084(4")
8826C	600810** See special notation	600614(Ax27)	600222(70MM)	ZA0085(5")
8826D	600810* See special notation	600617(Ax29)	600222(70MM)	ZA0086(6")
8825 HP B	600813*** See special notation	600617(Ax29)	600229(76MM)	ZA0050(6")
8825 HP C	600813*** See special notation	600621(Ax38)	600229(76MM)	ZA0144(8")
8825 HP D	600813*** See special notation	600609(Ax41)	600229(76MM)	ZA0145 (10")
8825B (RED)	600816(RED MOTOR)	600624(Ax25.5)	600222(70MM)	ZA0048(4")
8825C (RED)	600816(RED MOTOR)	600614(Ax27)	600222(70MM)	ZA0049(5")
8825D (RED)	600816(RED MOTOR)	600617(Ax29)	600222(70MM)	ZA0050(6")
8826B (RED)	600816(RED MOTOR)	600611(Ax26)	600222(70MM)	ZA0084(4")
8826C (RED)	600816(RED MOTOR)	600614(Ax27)	600222(70MM)	ZA0085(5")
8826D (RED)	600816(RED MOTOR)	600603(Ax30)	600222(70MM)	ZA0086(6")
8825HPB (RED)	600814(RED MOTOR)	600617(Ax29)	600227	ZA0050(6")
8825HPC (RED)	600814(RED MOTOR)	600621(Ax38)	600227	ZA0144(8")
8825HPD (RED)	600814(RED MOTOR)	600609(Ax41)	600229(76MM)	ZA0145 (10")
Turbo-Drive				
Replacement Motor				
Replacement Belt				
Motor Pulley				
Driven Pulley				
8855A	600812(RED MOTOR)	600614(Ax27)	600227(114MM)	ZA0047(3")
8855B	600812(RED MOTOR)	600617(Ax29)	600227(114MM)	ZA0048 (4")
8855C	800812(RED MOTOR)	600603(Ax30)	600227(114MM)	ZA0049(5")
8855D	800812(RED MOTOR)	600607(Ax31.5)	600227(114MM)	ZA0050(6")
Sheet Door				
Replacement Motor				
Replacement Belt				
Motor Pulley				
Driven Pulley				
815SD	600805	600620(Ax35)	600220(50MM)	600231(8")
815SL	600805	600621(Ax38)	600220(50MM)	600231(8")
8815SD***	600810 See special notation	600621(Ax38)	600222(70MM)	699231(8")
8815SD	600816(RED MOTOR)	600621(Ax38)	600222(70MM)	699231(8")
815SS	600805	600602(Ax23)	600219(46MM)	ZA0050(6")
825SS	600805	600615(Ax25)	600219(46MM)	ZA0050(6")
827	600805	600626(Z17.5)	600245	600242
Notes:				
***Part no longer available- Replacement motor bolts in place of existing unit				

PULLEY/BELT/MOTOR REFERENCE US

ZAP Series II Simply Logical

ZAP Controls
100 Waterloo Blvd. Anglesey Business Park, Littleworth Road, Cannock, Staffordshire, England
UK Office Number 011-44-154-387-9444 sales@zap-uk.com
Online www.zap-uk.com

ZAP Control

Motor Replacement Parts

ZAP Controls
Motor Replacement Parts

Complete Motor Heads		Motor Head Replacement Parts	
825-HW(X)	Complete 825 motor head/mounting hardware. Denote desired pulley size (B,C,D) in place of (X)	900035	Small Offset Torque Arm 1.4"
8825-HW(X)	Complete 8825 motor head/mounting hardware. Denote desired pulley size (B,C,D) in place of (X)	900005	Large Offset Torque Arm 2.3"
8825-HP-HW (X)	Complete 8825HP motor head/mounting hardware. Denote desired pulley size (B,C,D) in place of (X)	900004	Spacer Bushing 10pk
815SL-HW	Complete 815SL motor head/mounting hardware.	ZA0158	M5 lock washer for Bowden Cable 10pk
8815SD-HW	Complete 8815SD motor head/mounting hardware.	ZA0159	M5 Nut for Bowden Cable 10pk
825SS-HW	Complete 825SS motor head/mounting hardware.	ZA0160	E clip for Bowden Cable 10pk
827-HW	Complete 827 motor head/mounting hardware.	501255	4' Bowden Cable
Motor Head Replacement Parts		501250	6.5' Bowden Cable
600805	Replacement Motor 825	501256	12.25' Bowden Cable
500271	Motor bolts for 825	501262	18' Bowden Cable
ZA0182	Woodruff key for 825 motor shaft 10pk	900088	Replacement Bowden Cable Mounting Bracket
ZA0155	M5x20mm Washer for 825 motor pulley 10pk	ZA0161	D-Shackle 10pk
ZA0156	M4 Spring Washer for 825 motor pulley 10pk	600231	Replacement pulley door Dead Axle Sheet Door Operator (8")
ZA0154	ZA0154 M4x8mm screw for 825motor pulley 10pk	900068	Tongue for Dead Axle Sheet Door Operator
600220	50mm Drive Pulley 825-B	900081	Tongue for Dead Axle Sheet Door Operator-Janus
600219	46mm Drive Pulley 825-C&D Models	500065	Mounting Bolts for Dead Axle Sheet door operator tongues
600816	Replacement Motor 8825 (RED)	500322	Set Screw for Dead Axle Sheet Door Operators
600814	Replacement Motor 8825-HP Red	600242	Pulley for 827
600812	Replacement Motor 8855 Red	501626	Large Manual Over-ride Lever
500261	Motor bolts for 8825/8825hp	ZA0072	13' Tensioning Chain
ZA0181	3mm sq keys for 8825/8825HP/8855 motor shafts 10pk	601420	23' Hoist Chain
ZA0157	Cir-clip for 8825 motor pulley 10 pk	Replacement Belts	
600222	70mm Drive Pulley 8825/8826	600613	AX 19 Belt
600227	Drive Pulley 8825-HPB/C	600600	AX20 Belt
600229	Drive Pulley 8825-HPD	600601	AX21 Belt
601200	Super Drive Bearing (2 Required)	600612	AX22 Belt
ZA0048	(4")Driven Pulley 825/8825/8855-B	600618	AX22.5 Belt
ZA0049	(5")Driven Pulley 825/8825/8855-C	600602	AX23 Belt
ZA0050	(6")Driven Pulley 825/8825/8855-D 8825HP-B	600606	AX24 Belt
ZA0144	(8")Driven Pulley 8825-HP-C (1.25" Bore)	600615	AX25 Belt
ZA0145	(10")Driven Pulley for 8825-HP-D (1.25" Bore)	600624	AX25.5
ZA0084	(4") Tapped Driven Pulley for 8826-B	600611	AX26 Belt
ZA0085	(5") Driven Pulley 8826-C	600614	AX27 Belt
ZA0086	(6") Driven Pulley for 8826-D	600616	AX28 Belt
ZA0168	Set screw for sectional door operator pulley	600617	AX29 Belt
ZA0169	Lock nut for set screw	600603	AX30 Belt
500261	M6x20mm Screw 10pk	600604	AX31 Belt
500262	M6x45mm Screw 10pk	600607	AX31.5
500463	M6 Flange Nut 10pk	600620	AX35 Belt
900004	Spacer Bushing 10pk	600621	AX38 Belt
		600609	AX41 Belt

ZAP Series II
Simply Logical

ZAP Controls
100 Waterloo Blvd. Anglesey Business Park, Littleworth Road, Cannock, Staffordshire, England
UK Office Number 011-44-154-387-9444 sales@zap-uk.com
Online www.zap-uk.com

PARTS US

ZAP Controls

Controller and Accessory Replacement Parts

ZAP Controls
Controller and Accessory Replacement Parts

Controllers		Accessory Replacement Parts	
800-II-PB	800 Series II Complete replacement controller.	822	Driver Com Light Control Module w/advance closure warning
8800-II-PB	8800 Series II Complete replacement controller	850	Beeper Module
8800-II-HP-PB	8800HP Series II Complete Replacement Controller	840	Receiver
8850-STD-PB	8850 Standard Complete Replacement Controller	2416	Internal Antenna
8800-FS-PB	8850 Fire Station Complete Replacement Controller.	2414	External Antenna
Controller Parts		4113	4 channel Key Chain Transmitter
201833	Replacement Weather Proof Open or Close Button	400402	CR292 Battery 20Pk
201834	Replacement Weather Proof Stop Button	4202	2 Channel Transmitter with Visor clip
ZA0143	Cable Gland Kit	400409	CR1632 Battery 25 pk
ZA0142	8m Replacement Motor Cable	4305A	6 Channel Handheld transmitter
300008	Replacement Power Plug (Green)	4501-50	1 Channel indoor forklift transmitter
300017	Replacement terminal plugs (Strip of 20)	4502-50	2 Channel indoor forklift transmitter
300007	Replacement transformer plug	4504-50	4 Channel indoor forklift transmitter
ZA0171	Fuse. 5 x 20mm. 1 Amp. (10 PK)	4506-50	6 Channel indoor forklift transmitter
ZA0172	Fuse. 5 x 20mm. 2 Amp. (10 PK)	4501-66	1 Channel outdoor forklift transmitter
ZA0173	Fuse. 5 x 20mm. 3 Amp. (10 PK)	4502-66	2 Channel outdoor forklift transmitter
ZA0174	Fuse. 5 x 20mm. 4 Amp. (10 PK)	4504-66	4 Channel outdoor forklift transmitter
ZA0175	Fuse. 5 x 20mm. 5 Amp. (10 PK)	4506-66	6 Channel outdoor forklift transmitter
ZA0176	Fuse. 5 x 20mm. 6.3 Amp. (10 PK)	1102	Replacement Single Magnetic Loop Detector
400001	Replacement Fuse Cover	1100	Replacement single magnetic loop detector for 1100-CC
ZA0180	Microprocessor removal tool	1104-120	Replacement Twin Magnetic Loop Detector for 1104-120-CC
871	Interface Expansion Module	1104-240	Replacement Twin Magnetic Loop Detector for 1104-240-CC
871FS	Fire Station Module	503025	Replacement Loop detector case w/clear cover (1100,1104)
872	Adapter Module	Notes:	
82DTLM	Dock Interlock/Driver Communication Light Control Module		
ZA0192	Slave Relay Kit for 82DTLM		
82TLM	Closed Door Interlock/Through Traffic Light Control Module		
821	Through Traffic Light Module w/advance closure warning		

ZAP Series II Simply Logical

ZAP Controls
100 Waterloo Blvd. Anglesey Business Park, Littleworth Road, Cannock, Staffordshire, England
UK Office Number 011-44-154-387-9444 sales@zap-uk.com
Online www.zap-uk.com

PARTS US

ZAP Series II
Simply Logical

ZAP Controls
100 Waterloo Blvd. Anglesey Business Park, Littleworth Road, Cannock, Staffordshire, England
UK Office Number 011-44-154-387-9444 sales@zap-uk.com
Online www.zap-uk.com